



SUGAR BREEZE

CANVAS SARASOTA

LUXURY E-HOME

E-HOME FEATURES

- GREEN BUILDING
- ENERGY EFFICIENT
- SAFE & SECURE
- FIREPROOF
- TERMITE PROOF
- ECOLOGIC
- ACOUSTIC
- THERMAL WALLS

AREA: 2,600 S.F UNDER HVAC



3 BEDS



3.5 BATH



2 GARAGES



FLEX
ROOM



DETACHED
UNIT



FIRST FLOOR:

- FLEXIBLE ROOM AT THE ENTRANCE FOR AN OPTION OF STUDIO, GYM, OR GUEST ROOM.
- GREAT ROOM AREA WITH DISTINCTIVE LIVING
- ITALIAN KITCHENS AND VANITIES BY ITALKRAFT
- POWDER BATHROOM
- LAUNDRY ROOM
- GARAGE
- BBQ AREA NEXT TO THE KITCHEN

SECOND FLOOR:

- MASTER AREA WITH SITTING ROOM AND PRIVATE BALCONY
- OVERSIZED SHOWER
- FREESTANDING TUB
- DOUBLE VANITY
- HIS AND HER'S WALK IN CLOSET
- TWO SECONDARY BEDROOM IN-SUITE
- OPTIONAL PLAY ROOM OR THIRD BEDROOM

CANVAS SARASOTA SUGAR BREEZE

FIRST FLOOR



SECOND FLOOR

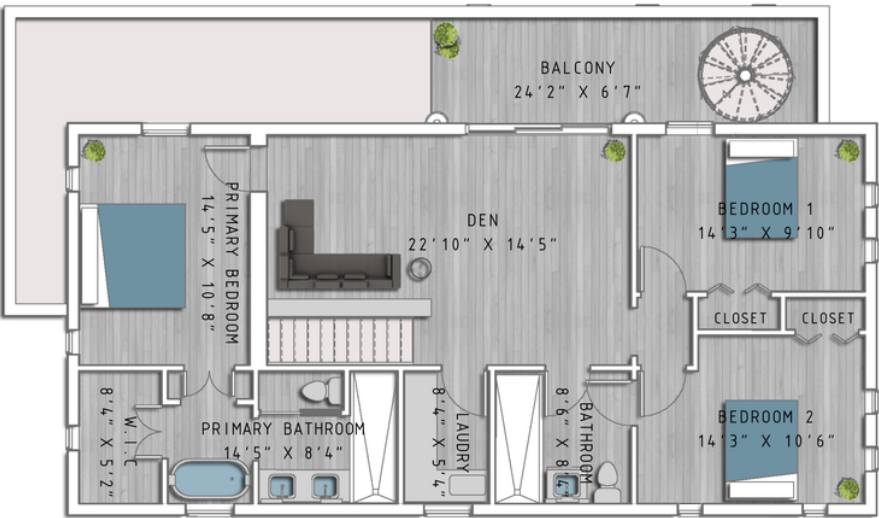

ORAL REPRESENTATIONS CANNOT BE RELIED UPON AS CORRECTLY STATING THE REPRESENTATIONS OF THE DEVELOPER. FOR CORRECT REPRESENTATIONS, MAKE REFERENCE TO THE DOCUMENTS REQUIRED BY SECTION 708.503, FLORIDA STATUTES, TO BE FURNISHED BY A SELLER TO A BUYER OR LEASE.



EFFICIENT
DEVELOPMENT GROUP

CONTACT
SALES@EFFICIENTDEVELOPMENTS.COM

EFFICIENTDEVELOPMENTS.COM

ABOUT OUR HOMES INCLUSIONS

- SEEKING THE FLORIDA GREEN BUILDING CERTIFICATE
- CAREFULLY THOUGHT OUT SPACIOUS FLOOR PLANS
- HIGH IMPACT WINDOWS
- UNIQUE WOOD-STYLE FLOORS THROUGHOUT
- FRONT LOAD FULL SIZE WASHER & DRYER
- BUILT-IN SPACE MAXIMIZING CLOSETS
- DIGITAL PROGRAMMABLE THERMOSTATS
- KEYLESS ENTRY
- DESIGNER LIGHTING FIXTURES
- METAL ROOFS
- GALVANIZED STEEL FRAME STRUCTURE
- HURRICANE PROTECTION ON SLIDING DOORS AND WINDOWS
- TERMITE-PROOF
- FIRE RESISTANT
- 8 MONTHS CONSTRUCTION SCHEDULE

ABOUT OUR KITCHENS

- QUARTZ COUNTER TOPS
- ITALIAN CABINETS WITH UNDER CABINET LIGHTING
- ISLAND AREA FOR ENTERTAINMENT
- TILE BACKSPLASH
- ITALIAN CABINETS PANTRY
- MULTI-FEATURE KITCHEN FAUCET
- STAINLESS STEEL HIGH EFFICIENCY APPLIANCES

ABOUT OUR BATHS

- DESIGNER VANITIES WITH LIGHTED MIRRORS
- FULL HEIGHT PORCELAIN WET WALLS IN SHOWERS & TUBS
- FRAMELESS GLASS SHOWER ENCLOSURES
- RAIN SHOWERS & HAND-HELD SHOWERS IN MASTER BATH

ORAL REPRESENTATIONS CANNOT BE RELIED UPON AS CORRECTLY STATING THE REPRESENTATIONS OF THE DEVELOPER. FOR CORRECT REPRESENTATIONS, MAKE REFERENCE TO THE DOCUMENTS REQUIRED BY SECTION 708.503, FLORIDA STATUTES, TO BE FURNISHED BY A SELLER TO A BUYER OR LEASE.