



Sri Sumeru Realty Pvt. Ltd.

Contact Us

Site Address :

SY No. 113 of Kaggalipura Village,
Uttarahalli Hobli, Bengaluru South Taluk,
Bengaluru Urban, Karnataka - 560082

Office Address :

Sri Sumeru Realty Private Limited
Gate No.7, 1st Floor, New Building,
Next To Sri Sri Publication Trust Office,
VVMVP Campus, The Art of Living International
Bengaluru, Karnataka - 560082

+91 74119 54272 | +91 74119 54273

enquiry@sumerurealty.com

www.sumerurealty.com

Rera Number - PRM/KA/RERA/1251/310/PR/060424/006779



Sri Sumeru Realty Pvt. Ltd.

HARIVISHRAM

“Embrace Nature, Experience Elegance”





Sri Sumeru Realty Pvt. Ltd.

About Us

At Sri Sumeru Realty Pvt. Ltd., We take pride in building happy homes and crafting Sattvic communities. Our goal is to create environments that nurture balance, simplicity and strong connections within the community.

Our Philosophy

We as a real estate company with a extensive strategy that ensures our projects provide beautiful living spaces, promoting luxury, well-being, and modern living. We accomplish this by applying Vastu principles, combining Traditional Indian methods, and balancing the five elements of nature (Pancha Tattvas).





HARIVISHRAM

Welcome to HariVishram, where "Sthiram Sukham" embodies a sattvic space for relaxation and comfort. Your living environment deeply influences your lifestyle and happiness, and Sri Sumeru Realty's beautifully designed community seamlessly blends elegance with lush green surroundings. Experience thoughtfully curated spaces, modern amenities, and a uninterrupted lifestyle near the vibrant International Art of Living Centre in Bangalore.



“Home is where you find joy in the little things.”



Blend with nature's panoramic view





Note : The Image is for representational purpose only, actual may vary at the site



Find your way with our map, highlighting landmarks and important locations near Harivishram.

Our Previous Projects:

Soudhamini
Surataru

Nearby Locations:

Vishalakshi Mantap
Sri Sri Tattva Panchakarma
Annapurna Kitchen



Harivishram

Surataru

Soudhamini

Annapurna
Kitchen

Vishalakshi
mantap

900 meters

Sri Sri Tattva
Panchakarma

Indoor



Table tennis

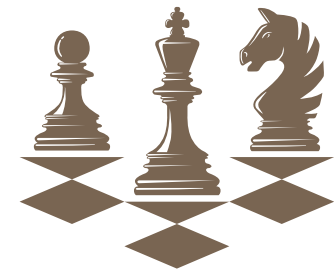

Chess

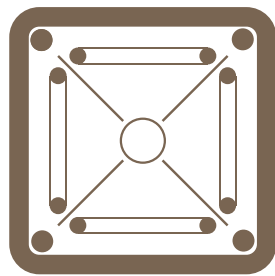

Carrom

Outdoor



Badminton



Children's Play Area



Half Basketball court

Cardio Training



Cycling Track



Jogging Track



Outdoor GYM



Outdoor Yoga Space

The amenities mentioned here are indicative and based on the current proposed construction plans. They are issued in good faith. The Promoters/Developers reserve the right to alter the layout, plans, specifications, or features without prior notice or obligation, subject to the approval of authorities or in the interest of the ongoing improvement and development of the Complex. The floor plans and images in the leaflets, brochures, or any other printed materials are indicative and artistically imagined and may not be exact or accurate. These do not form part of any offer or contract. Guidelines: No external installation of grills, flower pots, etc., outside windows or any changes to the external elevations.

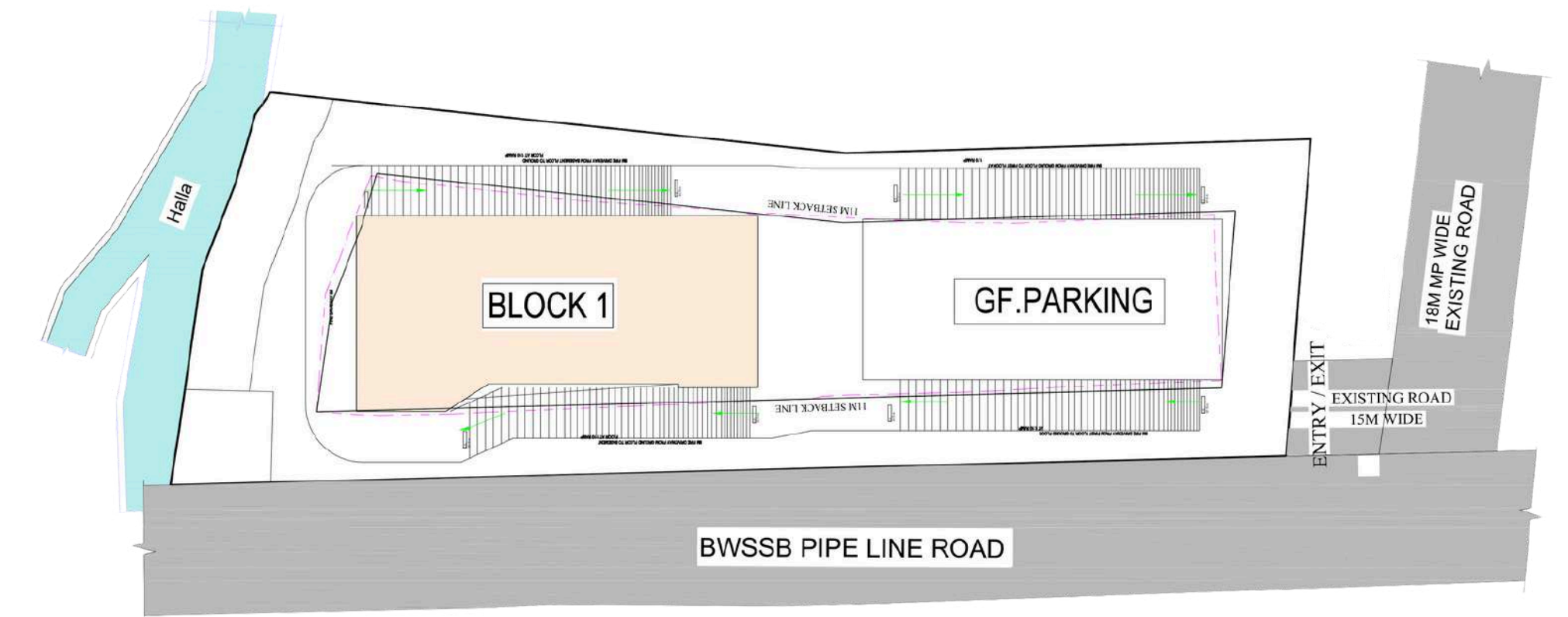

Block 1
First Floor Plan

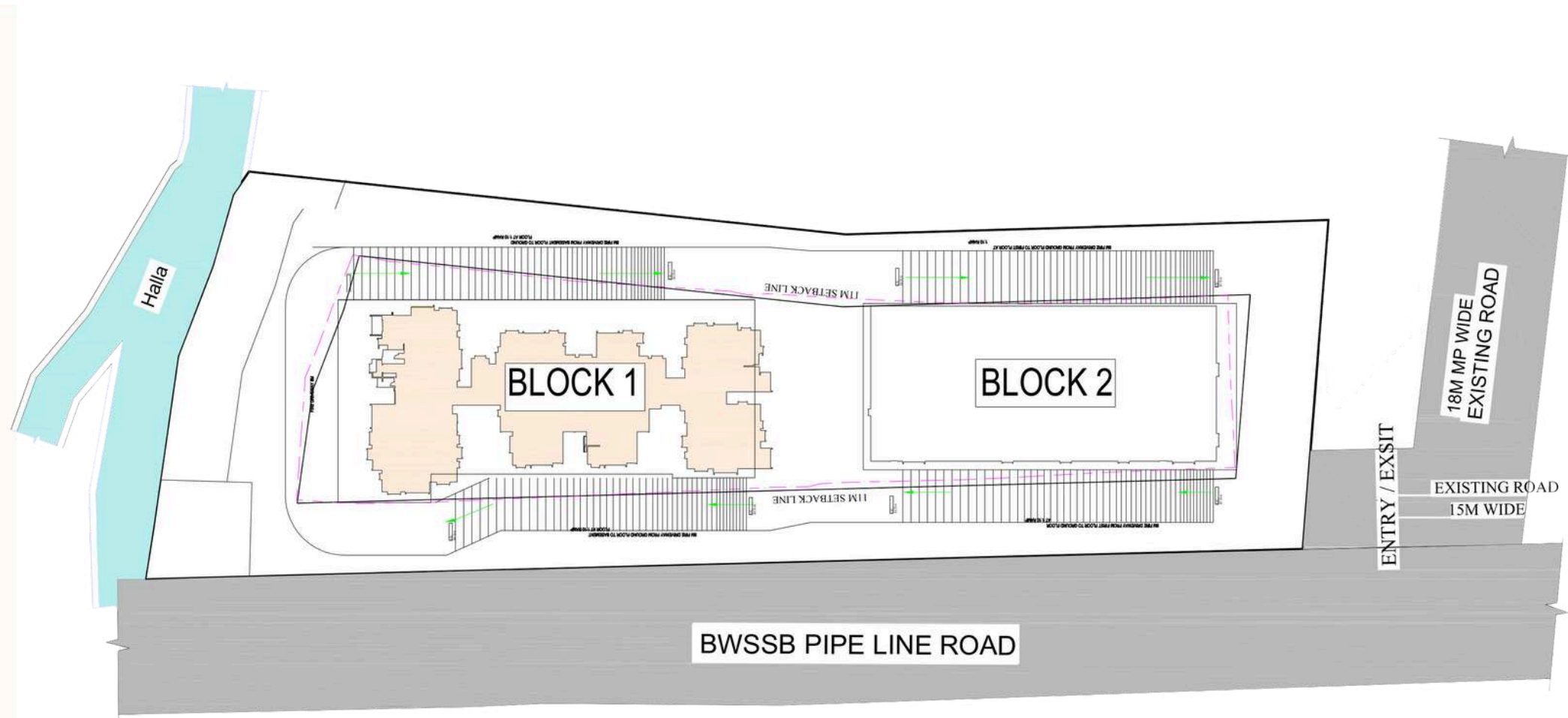

Block 1
Typical Floor Plan



‘Thoughtfully designed kitchen and cooking experience’

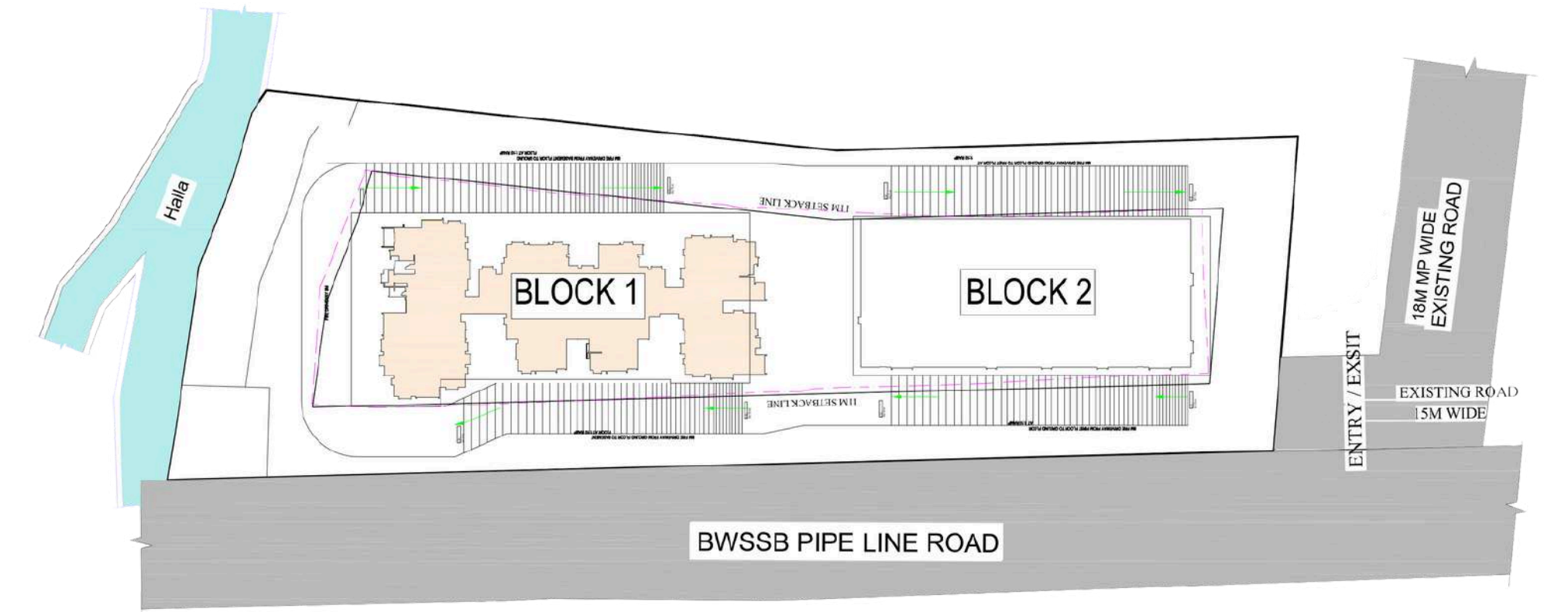
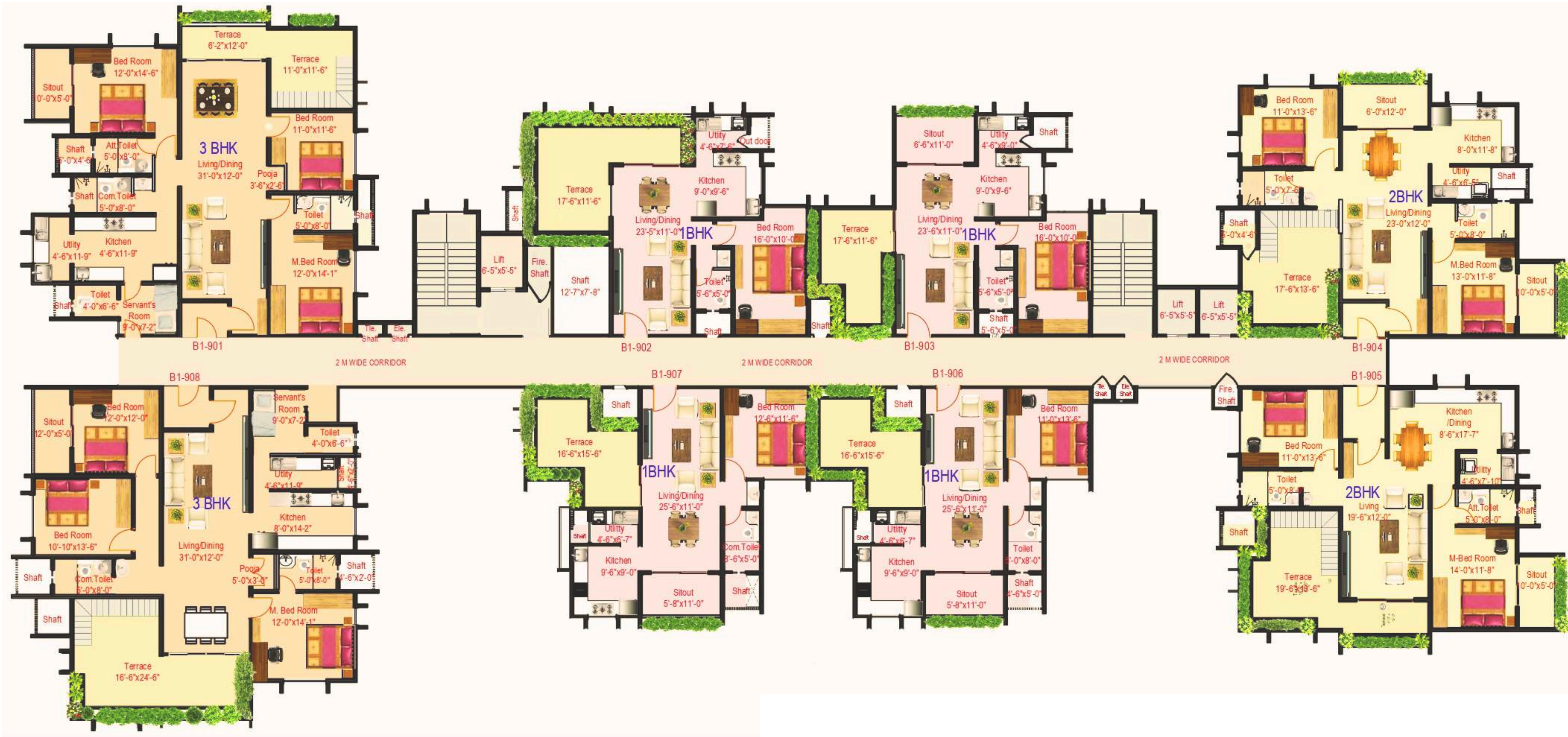

Block 1
Ninth Floor Plan

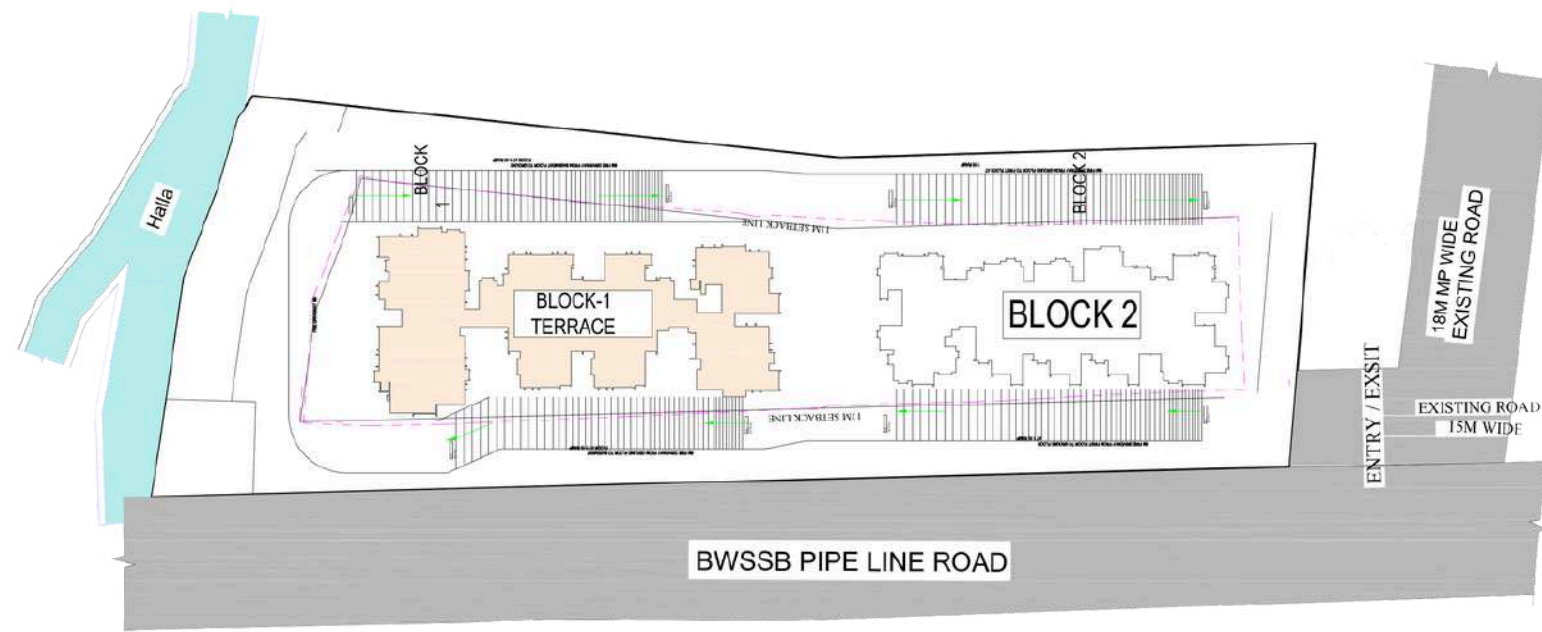

Spend quality time with your family in our rooftop gazebos, where stunning views and a cozy ambiance create the perfect setting to relax and make lasting memories together.

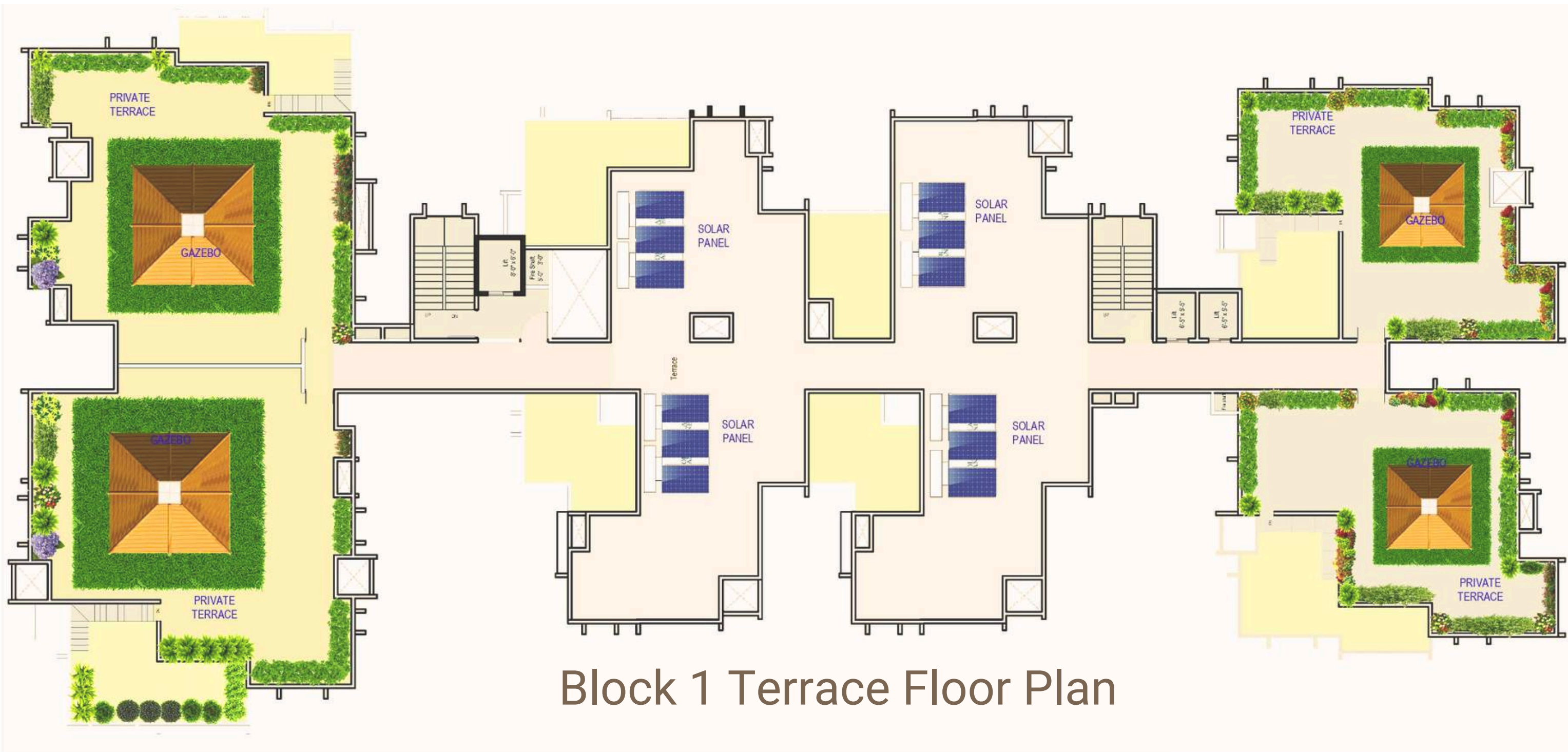

Block 1 Terrace Floor Plan



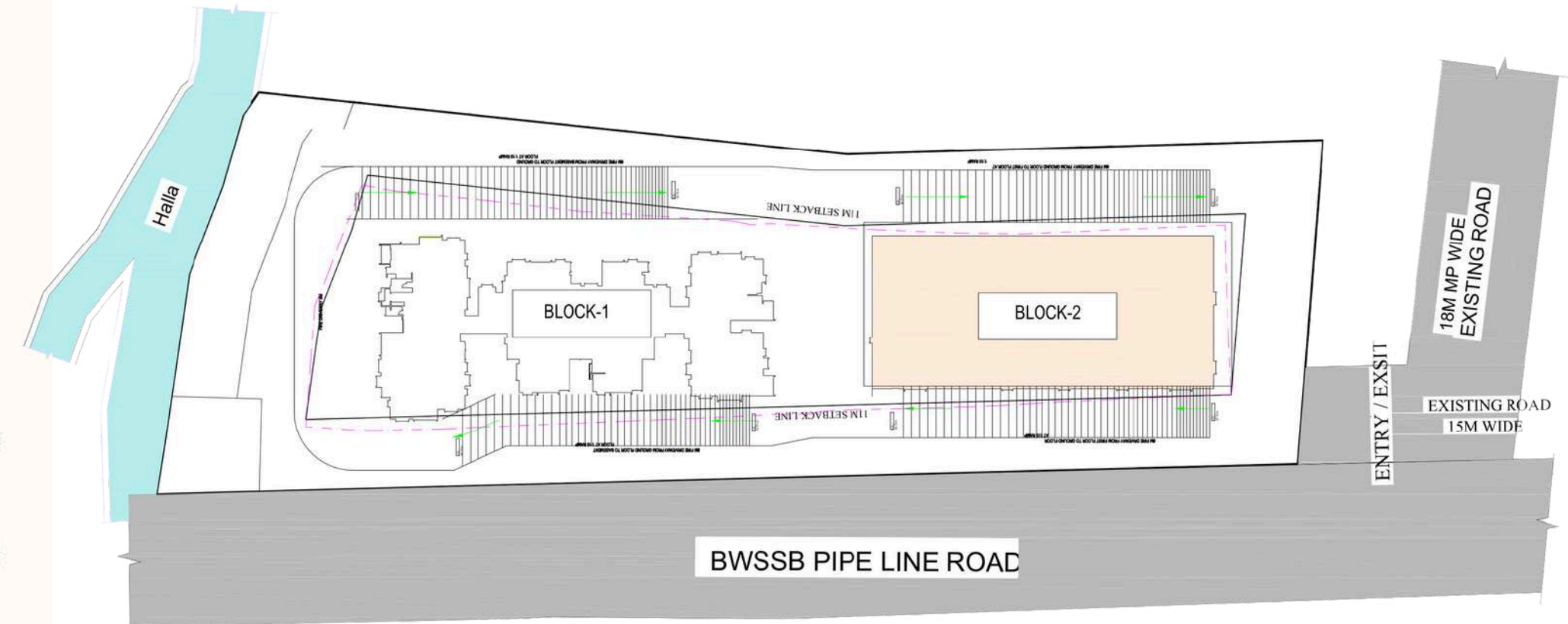
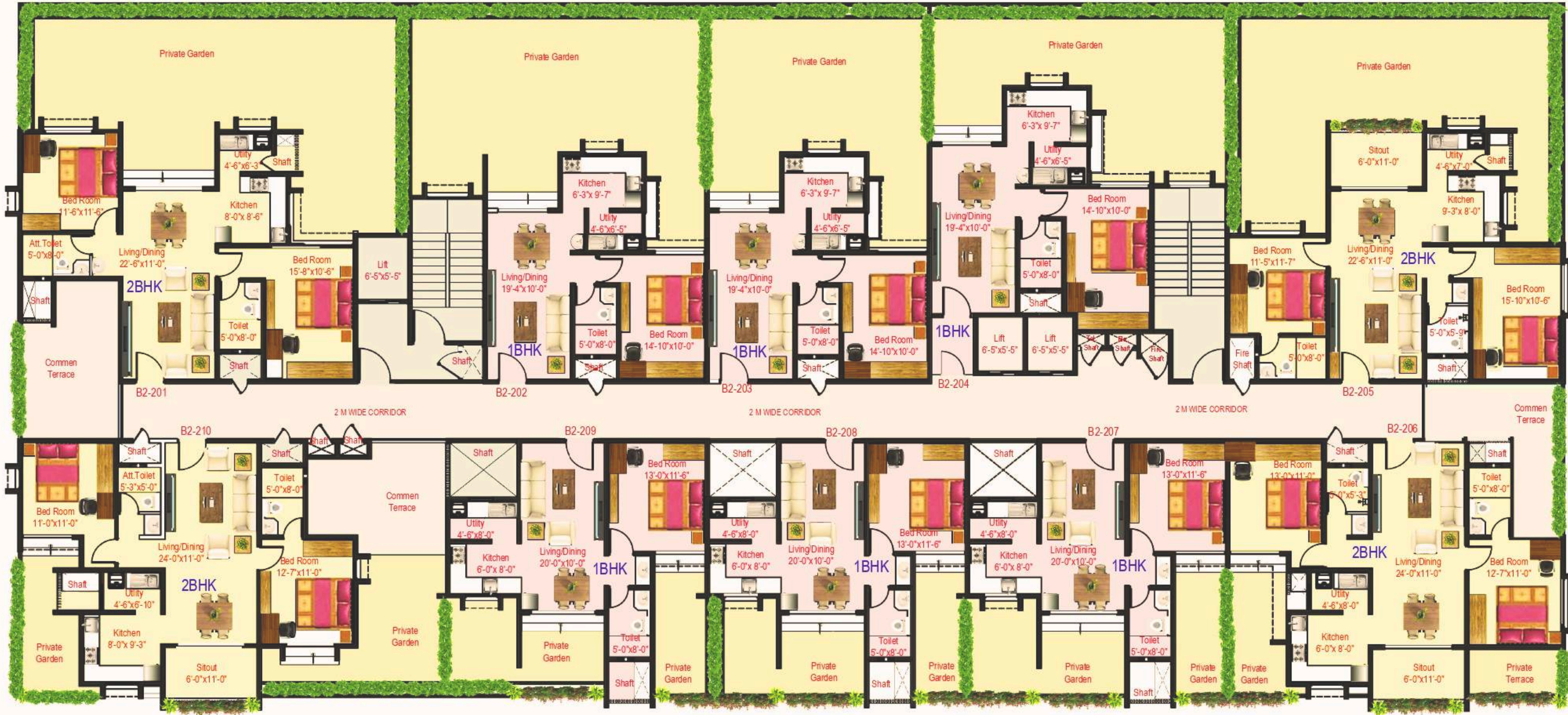

Block 2
Second Floor Plan

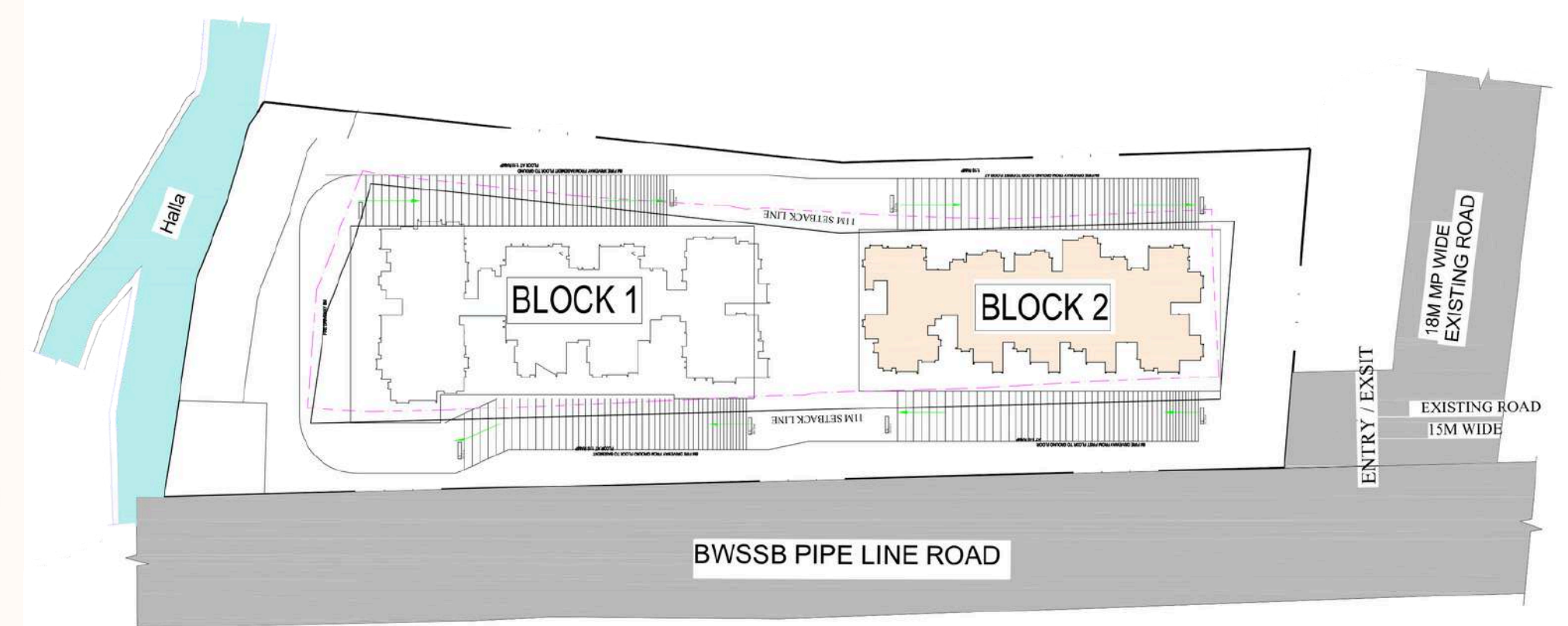

Block 2
Typical Floor Plan

Detailed Floor Plan of 4BHK Apartment

- Spacious 4 BHK unit with super built-up area of 2391 sq ft along with pooja room
- Master bedroom has a splendid view of vishalakshi mantap from Full sitout balcony



ILLUSTRATION UNIT

Detailed Floor Plan of 3BHK Apartment

- Spacious 3 BHK unit Having super built-up area of 1793 sq ft
- Extra balcony attached to master bedroom
- Has a foyer space.

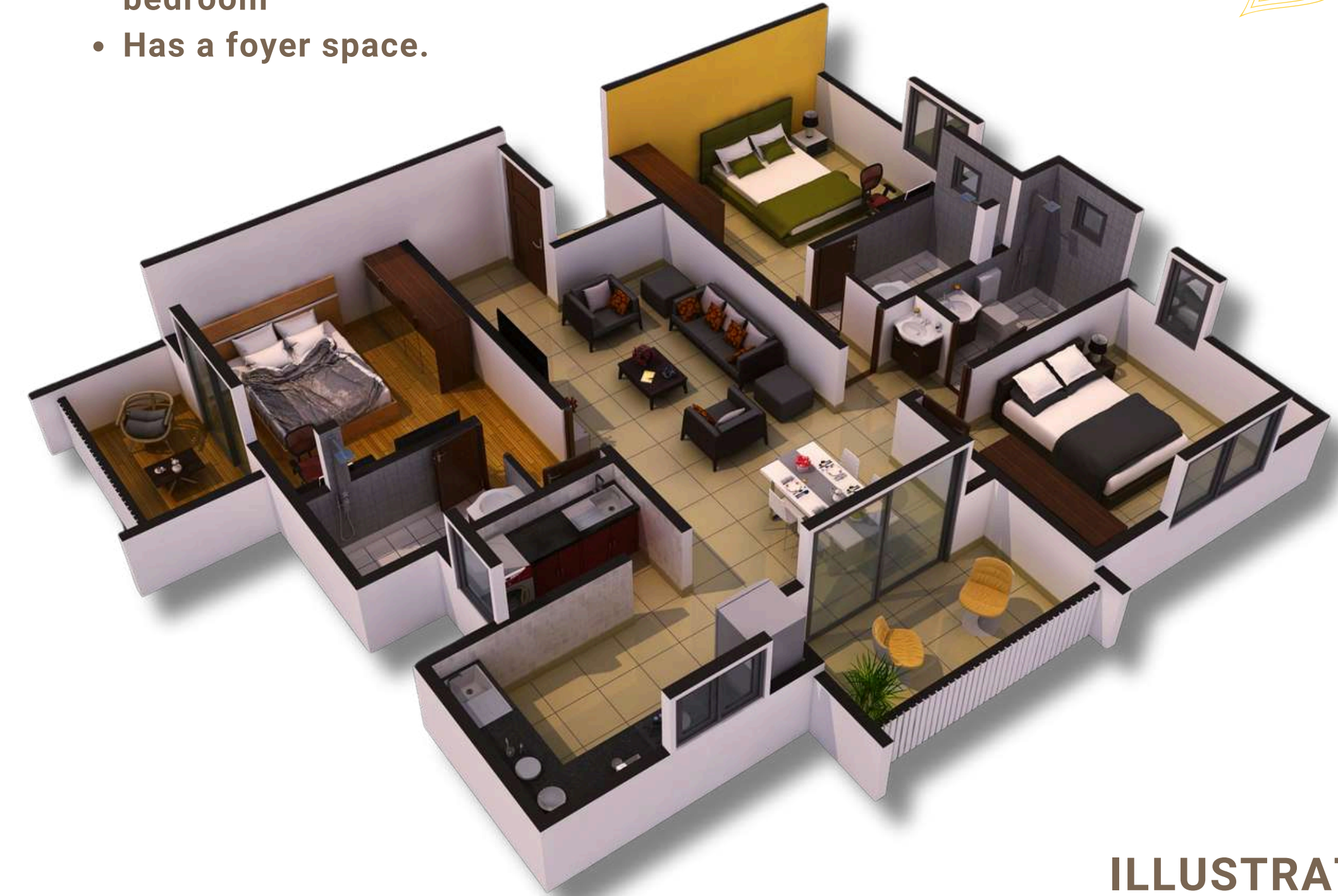
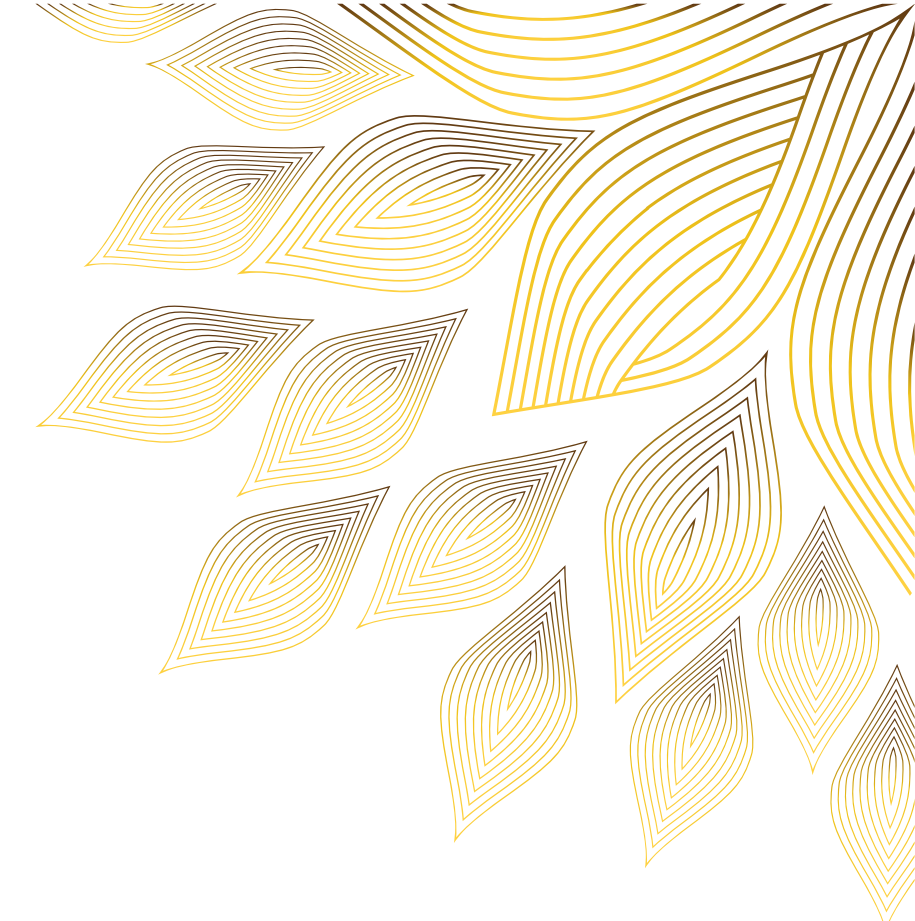

ILLUSTRATION UNIT

Note : Area mentioned in the plan is for representational purpose only, actual may vary at the site



Detailed Floor Plan of 2BHK Apartment

- Spacious 2 BHK unit with Having super built-up area of 1239 sq ft
- Balcony with a view of lush green landscape attached to the living room



ILLUSTRATION UNIT

Detailed Floor Plan of 1BHK Apartment

- Spacious 1 BHK unit with Having super built-up area of 822 sq ft



ILLUSTRATION UNIT

Note : Area mentioned in the plan is for representational purpose, actual may vary at the site

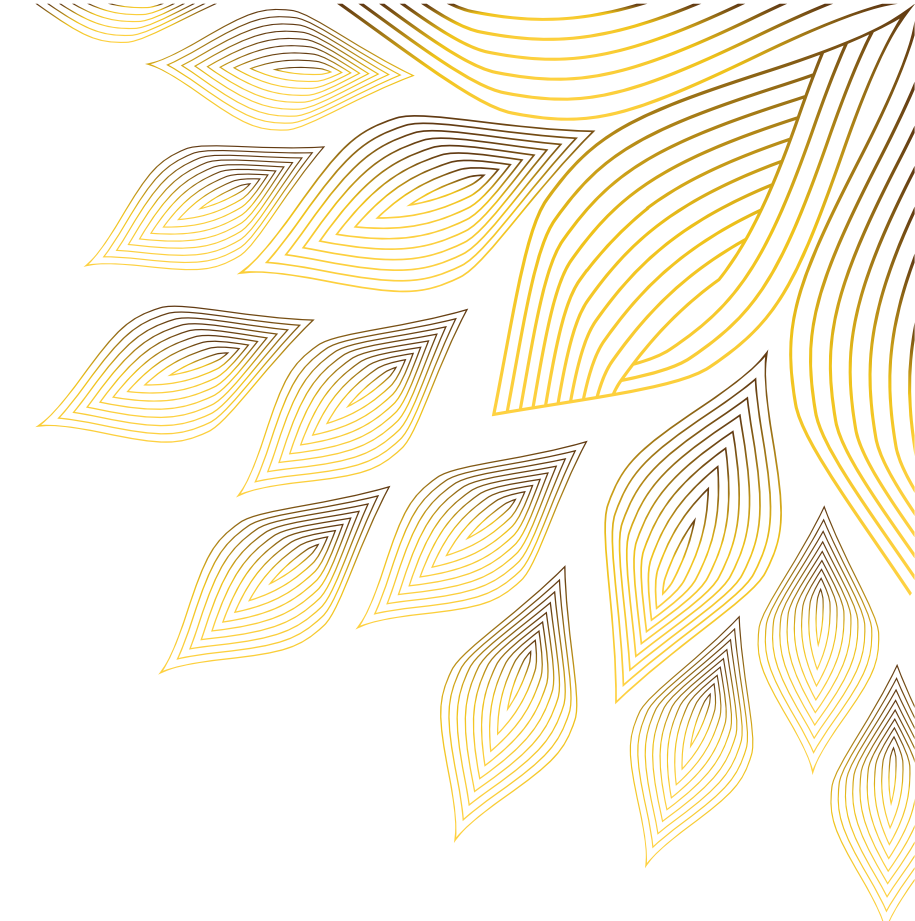



SPECIFICATION DETAIL

STRUCTURE:

- Precast Structures

FLOORING

- Vitrified Tile flooring in living, bathrooms & kitchen
- Anti-Skid ceramic flooring for bathrooms, utility & balconies

DOORS

- Main Door : wooden frame
- Internal Doors: wooden frame
- Toilet Doors: WPC frame





SPECIFICATION DETAIL



WINDOWS

- UPVC window with MS grill
- Glass Railing in Balcony area

PARKING

- Adequate parking space

KITCHEN

- Polished granite platform with S.S Sink
- Ceramic tile dado up-to 2 feet above ceramic platform
- Provision for water purifier
- Electrical points for chimney and other electrical appliances

PAINT

- External walls with waterproof paint
- Internal walls with putty and double coated paint



SPECIFICATION DETAIL

PLUMBING

- Concealed plumbing with hot & cold mixer unit in bathroom

LIFTS

- Branded passenger lift with power back-up

ELECTRICAL

- ELCB and MCB for every apartment
- Modular switches
- AC points in master bedroom and living rooms





At HariVishram, we prioritize sustainability through advanced green building practices. Our eco-friendly designs incorporate energy-efficient materials and technologies to minimize environmental impact and promote a healthier planet.

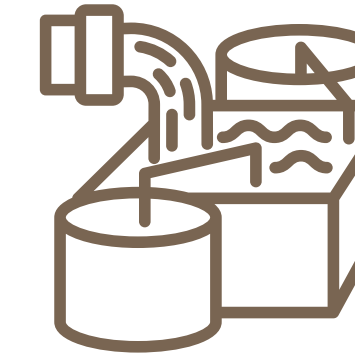

HariVishram's Specific Treatment Plants (STPs) utilize advanced technology to efficiently treat and manage wastewater, ensuring minimal environmental impact and promoting a cleaner, more sustainable community.



Our state-of-the-art rainwater harvesting systems at HariVishram capture and store rainwater, reducing reliance on municipal supplies and supporting eco-friendly living by conserving valuable water resources.



Our projects feature solar panels that harness renewable energy to power common areas and amenities, reducing reliance on non-renewable sources and enhancing overall energy efficiency.



Explore the prestigious awards and recognitions received by Sri Sumeru Realty Pvt. Ltd. for our exceptional work in crafting outstanding living spaces.