

Hydraulic Crawler Drill JRD Model T51 Heavy Duty Self-propelled Crawler mounted Drilling Rig

T51 is Hydraulic self-propelled, self-contained, Crawler mounted surface drilling Rig with extensive boom reach. T51 is specially used in road construction, demolition works, secondary breaking, foundation drilling, trenching and Drilling & Blasting.

Hole Diameter	45 - 64 mm (1½"-2½")
Rock Tools	R32, T35, T38
Extension Rod Length	3.05mtrs. (10ft) / 3.66mtrs. (12ft)
Rock Drill	14kW
Flushing Air	5.2m ³ /min, up to 7bar
Weight	9500 kg





FOLDING BOOM TYPE

T51 Boom is specially designed to have extensive reach that lets you drill more holes per set-up.

Great reach and productivity Boom reach of 5300 mm through an 80° radius translates into more holes from fewer set-ups. This versatility makes T51 an ideal choice for demanding construction jobs, such as road construction, foundation and trench drilling and also for drilling & blasting.

T51 excels even in difficult terrain where its low center of gravity provide rugged mobility in all conditions. The operator has full control over tramming and drilling while working at a safe distance from the rig – ideal for sites with limited access or unstable terrain.



MAST

Sturdy structural Channel Type Mast steel material reinforced with suitable cross members strong enough to withstand high drilling loads. Mast Tilt, Swivel and Dump and Boom Lift and Swing by suitable Hydraulic Cylinders.

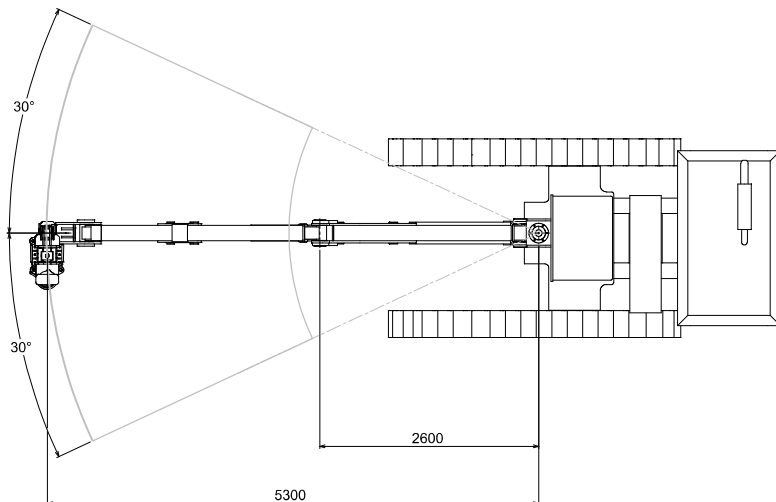

Horizontal reach and coverage area

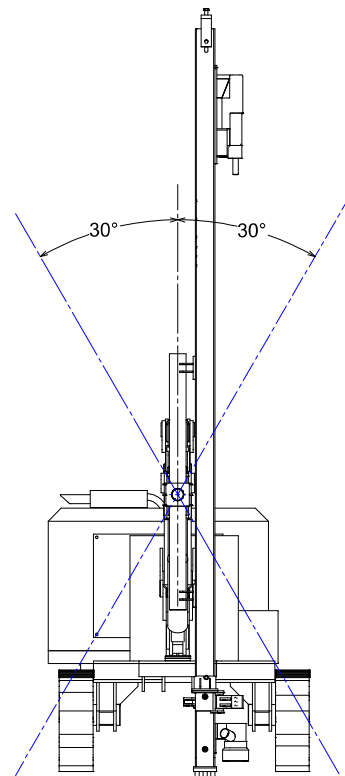

**Normal position range in downwards
(extra long folding boom)**

Technical Specification

Hole Diameter	45 - 64 mm (1¾" – 2½")
Rock Tools	R32, T35, T38
Extension Rod Length	3.05mtrs. (10ft) / 3.66mtrs. (12ft)

Hydraulic Rock Drill

Model:	RD32 Plus
Rock Tools	R32, T35, T38
Operating Pressure	110~220Bar
Percussion Rate	56~76Hz
Percussion output Power	14Kw
Max Rotation Torque	680Nm
Shank Lubrication	Air/Oil mist
Flushing	Air
Weight	180kgs

FEED

Extra Long folding boom	
Total Length	5500mm
Travel Length	4070mm
Feed Extension	750mm
Type of Feed	Chain
Pull Down Force	0~2500 kgf
Pull Up Force	0~2500 kgf
Pull Up & Pull Down Speed	0~ 25mtrs./min

HYDRAULIC SYSTEM

Number of Pumps	1 for Rock Drill (Percussion) 3 for Drilling, Tramming, Boom, Dust collector & Cooler
Filtration rate	10micron abs
Cooling capacity	Up to +50°C
Hydraulic Oil Tank	300litrs

The hydraulic system is designed for high productive capacity. All hydraulic elements like Pumps, Motors, Valves and cylinders shall be of adequate capacity and of reputed make Fixed displacement Hydraulic Pumps with heavy duty Controls are used for Percussion, Rotation, Feed (for fast & micro feeding), Tramming and diversion valves are used for auxiliary drives like for Boom and Mast Operation etc.. All hoses shall withstand high pressure and high temperature. The Hydraulic oil shall be filtered during suction and return lines with operating pressure maximum 175bar

Dust Collector DCT

Filter Area	8m2
Suction Capacity at 500mm wg	580 l/s
Cleaning air pressure (max)	7.0bar
Cleaning air Consumption at 7bar	15 l/pulse
Filter Cleaning while drilling	

Engine-Hydraulic Power Pack

Model	ALHT4CTIC3
Power	75kW (101H.P)
Speed range	900~2200rpm
Bore & Stroke in mm	96x122mm
Max Torque at 1400~1600rpm	390Nm
Emission Standard	BS-III (CEV)
No. of cylinders	4
Engine configuration	Inline
Governor class	Mechanical A2
Aspiration	Turbocharger

COMPRESSOR

Screw Compressor Model: PG 185-100	
Working Pressure	7 Bar (100psi)
Free Air Delivery	5.2m3/min (185cfm)
Engine, Make: Kubota Model: V2403-M	
Rated Power	36.5kW (48.9HP)
Speed (@Rated power)	2700
Displacement	2.434L (148.5cu.in)
Bore & Stroke	87.0 x 102.4mm
Engine configuration	Inline
No. of cylinders	4
Aspiration	Naturally aspirated

Undercarriage System

Max. Speed	2.0 Km/h
Gradeability	75%
Track Shoe Type	Single Grouser Shoe
Wheelbase	2350mm
Track Shoe Width	260mm (10")
Ground Pressure	8.0 psi (0.55 kgf/cm2)
Oscillation	+/- 6°
No. of Roller (Lower)	7 (for each track)
No. of Roller (Upper)	1 (for each track)
Ground Clearance	400mm

Water Injection System (Optional)

WIP consists of Water Pump coupled to Hydraulic Motor delivering water into Top Hammer flushing tube at pressure 450PSI and is with 120litres Water tank.

FEED HEIGHT

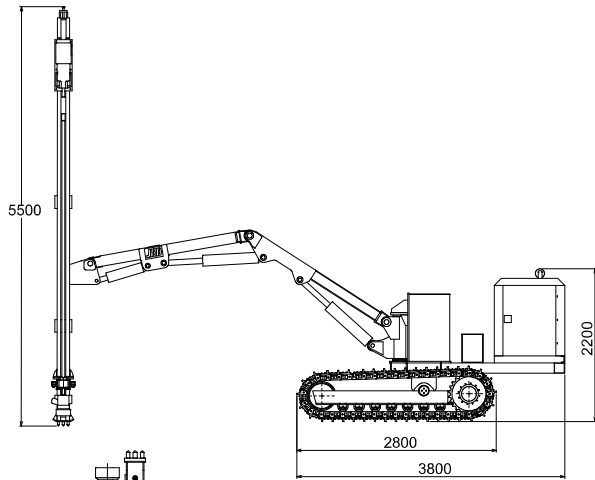

Vertical Reach (extra long folding boom)

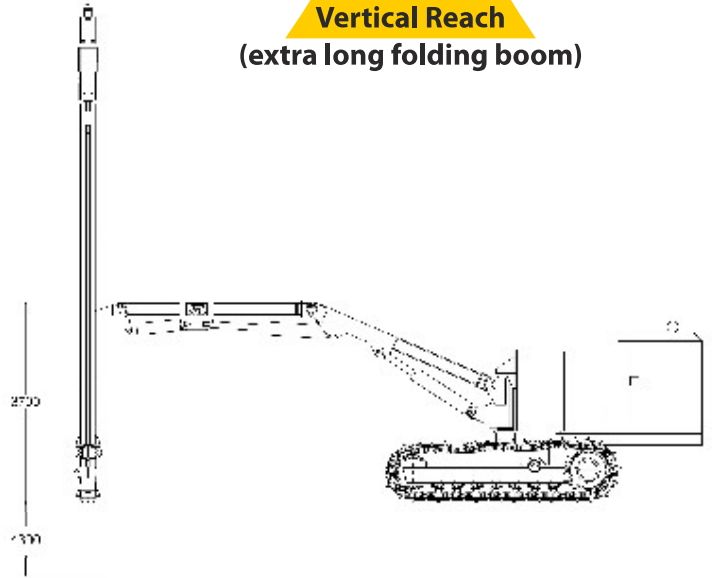

Dumping angles (extra long folding boom)

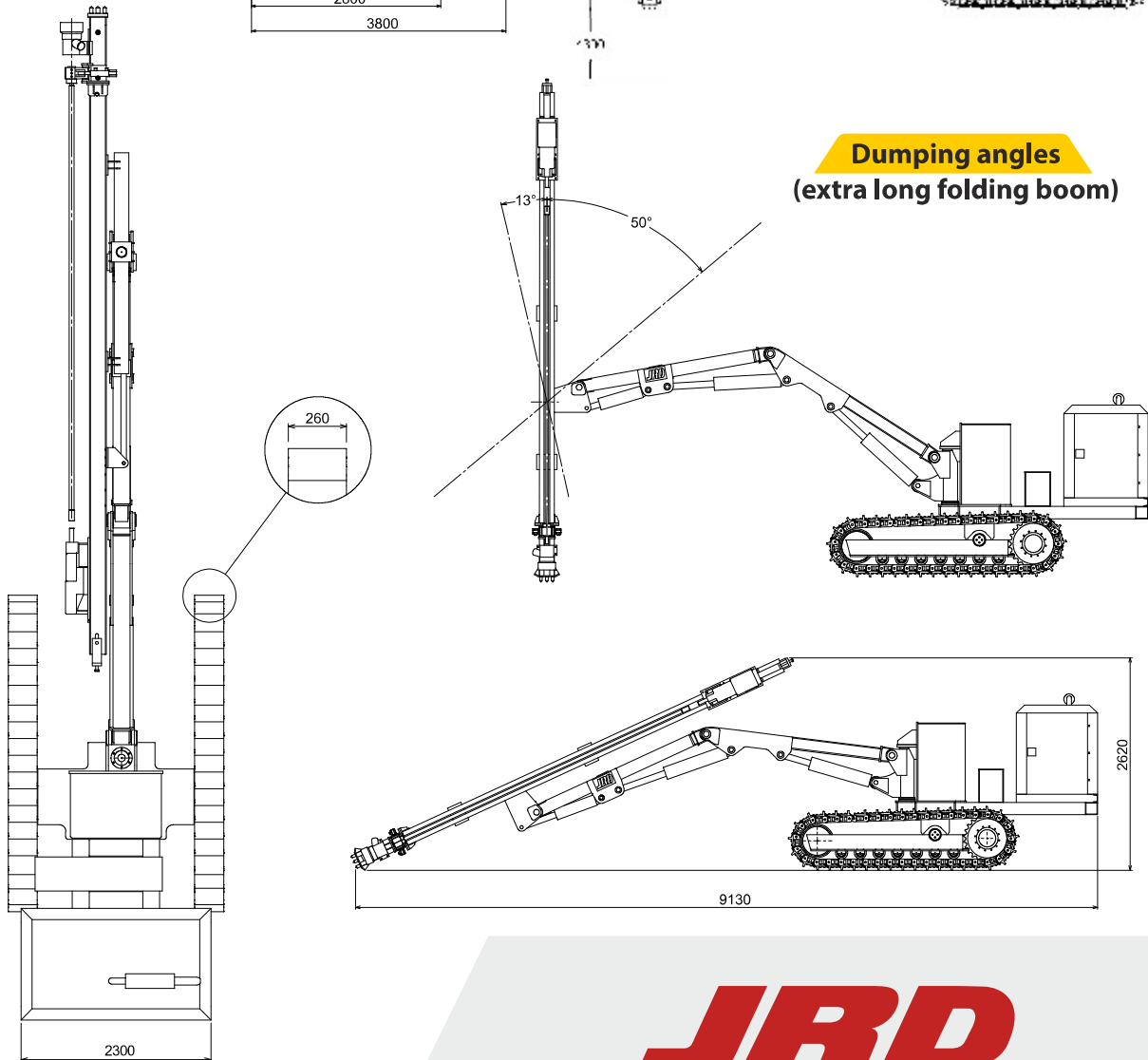

Weight & Dimensions

	Metric	US
Weight:	9500kg	21000lb
Length (Guide Horizontal position):	9130mm	30'
Width (Overall)	2300mm	7' 5"
Height (Guide Horizontal Position):	2750mm	9'

JRD
JUPITER ROCK DRILLS

JUPITER ROCK DRILLS PVT. LTD.

149 A & B, Phase - II, IDA,
Cherlapally, Hyderabad-500 051, INDIA.
Tele : 040 - 2988 2833 / 2988 2933 / 2726 1333
Fax : 040 - 2726 4336 Mob : 98494 28080
Email : sales@jupiterrockdrills.com
Web : www.jupiterrockdrills.com