

# MANUAL CHAIN BLOCKS AND LEVER HOISTS

## Chainblock Manual

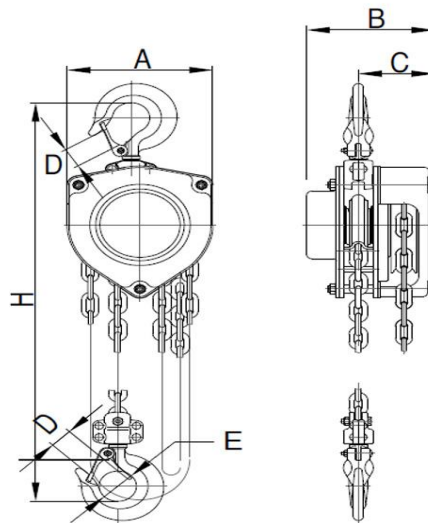

Capacity (ton)	Standard Lift (m)	Test Load (KN)	Effort required to lift max.Load (N/kg)	Load Chain Diameter (mm)	Extra diameter per meter extra lift (m)	Extra weight per meter extra lift (kg)	Dimensions (mm)					Packing Measurement (cm)	Net Weight (kg)
							A	B	C	D	H		
0.5	2.5	6.1	200(20.5)	6.0X1	33.3	1.7	137.5	137	270	35	28	22X15X19.5	8.4
1	2.5	12.3	300(32.5)	6.0X1	41.5	1.7	146.5	162	317	35.5	26	23x18x19.5	11
1.5	2.5	18.4	360(36.5)	8.0X1	55.6	2.3	170	183	399	45	32.5	28x21x24	16.2

2(s)	3	24.5	328(33.5)	6.0X2	83	3.4	146.5	189	440	42.5	32	25x20x19.5	14.6
2	3	24.5	365(37)	8.0X1	72.6	2.3	170	194	414	42.5	32	28x21x24	18.5
3	3	36.8	385(39)	8.0X2	111.2	3.7	170	220	465	50	37	32x21x26	25.6
5	3	61.1	435(44.3)	10.0X2	163.4	5.3	190.4	288	618	64	46	40x21x26	42.8
7.5	3	91.9	435(44.3)	10.0X3	245.1	7.5	190	377	768	64	46	50x41x21	62.5
10	3	122.5	435(44.3)	10.0X4	326.8	9.7	190	384	798	85	50	50x41x21	79.5
20	3	235.2	435X2(44.3X2)	10.0X8	327X2	19.4	209	625	890	110	81	64x38x64	193
30	3	367.5	435X2(44.3X2)	10.0X12	490.2X2	28.2	312	691	1380	110	81	72x50x68	220



# Leverhoist

## Manual

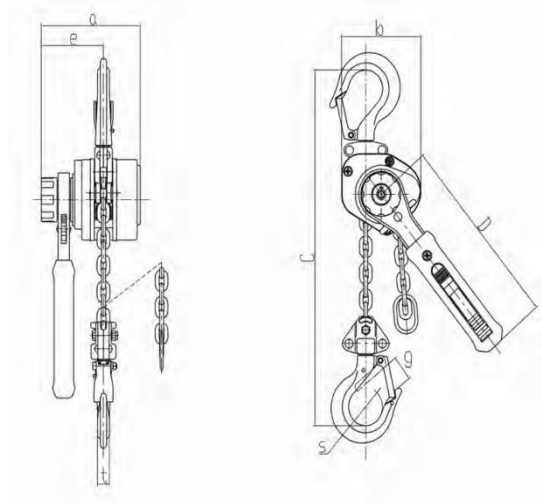

Capacity	tons	0.75	1.5	3	6	9
Standard Lift	m	1.5	1.5	1.5	1.5	1.5
Running Test Load	Kn	11.0	22.0	37.5	75	112.5
Effort required to lift max. Load	N	140	220	320	340	360
No. of columns of load chain		1	1	1	2	3
Load chain diameter	mm	6	8	10	10	10
Dimensions (mm)	A	148	172	200	200	200
	B	90	98	115	115	115
	C	136	160	180	235	320
	D	40	45	58	64	85
	H	325	380	480	620	700
	L	280	410	410	410	410
	K	34	38	48	52	58
Net Weight	kg	7	11	21	31	46
Packing measurement	cm	36x13.5x19	50x13.5x19	54x17x21.5	54x18x21.5	82x32x21.5
Extra weight per meter extra lift	kg	0.8	1.4	2.2	4.4	6.6

