

Submersible Electric Pumps

Low-Head Axial-Flow & Medium-Head Mixed-Flow Propeller Design



Heads up to 55ft./16.8M
Flows to 130,000 GPM/8.2 M³/S

The Power to Move Water® Since 1926
mwipumps.com





Available from 8 - 60", with heads from 5 - 55' and flows from 1,000 - 130,000 GPM, MWI high-volume, submersible electric pumps are extremely versatile, durable and reliable. These underwater pumps are available as medium-head, mixed-flow, and low-head axial-flow propeller designs. They are used in applications such as storm water drainage, flood control, irrigation, and final effluent pumping.

Where MWI Pumps are Used



MUNICIPAL

- Flood control & storm water drainage
- Emergency pumping
- River & stream bypass
- Final effluent



MINES & QUARRIES

- Open pit & underground drainage
- Process water supply & transfer
- Aggregate wash down



INDUSTRIAL

- Large-volume processes
- Temporary raw water
- Water management



MARINE

- Drydock
- Water transfer & waterway diversions
- Dam bypass
- Moving large volumes of water



AGRICULTURE

- Irrigation
- Aquaculture
- Flood control

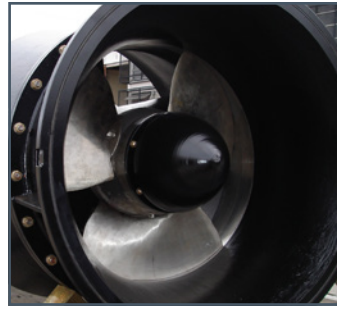

Versatile, Robust & Reliable

MWI offers a wide variety of discharge configurations, and every unit can be customized by our in-house professional engineering team to fit your jobsite specifications. MWI also creates retrofit or replacement pumps that fit into other manufacturer's submersible electric pump cans.

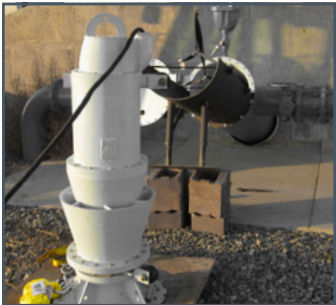

Features & Benefits

EFFICIENT, LOW-PROFILE

Simplified drive train with easy access points for maintenance

SIZE VARIETY & CAPACITY

Available in 8" – 60" (203mm – 1,524mm) diameters with capacities up to 130,000 GPM (8.2 M³/S)

INSTALLATION COST SAVING

Submersible Electric Pump designs can reduce costly civil works

DURABLE MOTOR HOUSING

304 Stainless steel motor housing comes standard on most models

QUICK & AFFORDABLE PARTS

Commercially produced, off the shelf available bearings, seals, and components make for quick allocation, cost effective, maintenance and repairs

CUSTOM DESIGNED FOR YOU

Each pump is custom designed and optimized to fit your pumping application

VERSATILE ORIENTATION

Can be installed at any angle for custom pump station design

BUILT TOUGH FOR LONG LIFE

Built with premium, tough, and corrosion resistant internal components for efficiency and long life service

EASY MAINTENANCE

Pump only lift-out design for easy routine maintenance or replacement

FIELD SUPPORT & OEM REPAIR

Fully-equipped repair facilities in Vero Beach & Deerfield Beach, FL for additional support if necessary

Installation Configuration

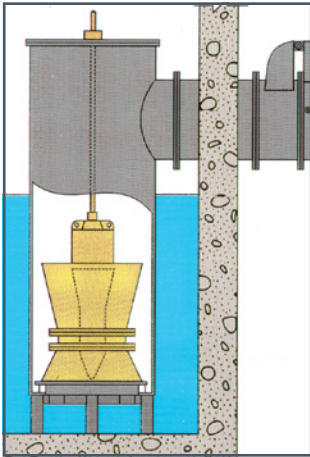

SELF-SUPPORTING VERTICAL CAN

- Self supporting can reduces civil costs
- Horizontal discharge pipe
- Lift out pump with intake bell makes for an all-in-one pump assembly

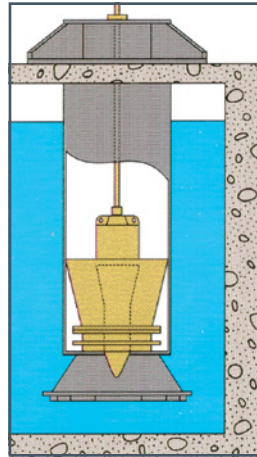

SUSPENDED VERTICAL CAN W/ EXTERNAL INTAKE

- Vertical discharge
- Lift out pump with fixed intake - External intake allows for smaller discharge can diameters when space is limited

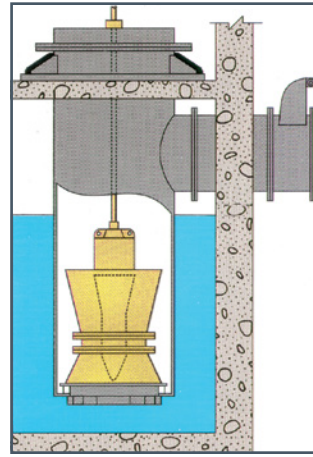

SUSPENDED VERTICAL CAN W/ ALL-IN-ONE PUMP & INTAKE

- Vertical discharge
- All in one lift-out pump provides access to entire pump assembly

MWI's submersible electric pumps are built with an impeller that's directly connected to the motor. These high-volume submersible pumps are available in multiple configurations, including canned or enclosed as well as vertical, horizontal, or any angle in between. Our electric submersible pumps are easy to maintain and offer a quiet operation as well as a low profile.

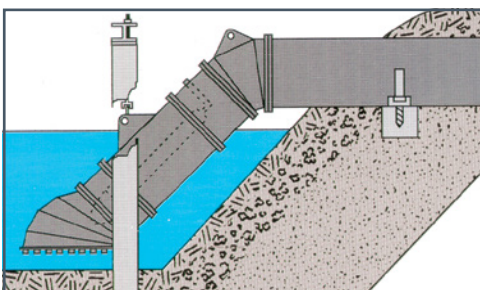

45° PUMP W/ 45° INTAKE BELL

- Horizontal discharge pipe
- Simple support structure
- Reduced civil costs

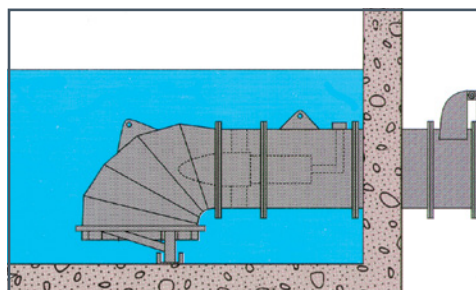

SELF-SUPPORTING HORIZONTAL CAN

- Horizontal discharge pipe
- Lift-out pump with intake bell
- Extremely low profile pump station

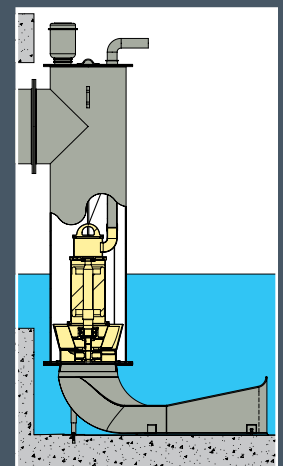

FORMED SUCTION INTAKE (FSI)

- Inlet device provides optimal flow to the impeller
- Helps to straighten non-uniform approach flow
- Extremely effective in cross-flow applications or for pump stations with difficult inflow conditions
- Minimizes sump dimensions

Options

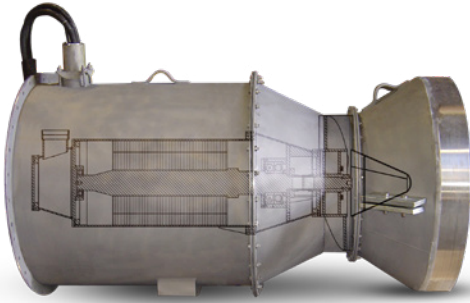

All 316L Stainless Steel Horizontal SEA330
30in. Impeller bolt on discharge pipe inline pump design, 1.74 M³/S at 1.2M TDH, 75 HP direct drive electric motor with 316L stainless steel motor housing.

MOBILE SUBMERSIBLE ELECTRIC PUMP



The Mobile Submersible Electric Pump and Generator is a unique product designed for municipalities and contractors who need emergency lighting, power, and/or large volume pumping in special situations. This portable electric water pump system features a submersible electric pump, diesel-powered generator, pump control panel with instrumentation, and telescoping light tower.

The generator can be used to power auxiliary equipment while pumping or as a full power standalone unit. Once the unit has been brought to the jobsite, it can be fully operational in minutes. MWI's mobile pump station can run for 48 hours utilizing the standard 110-gallon fuel tank.



MWI's electric pumps helped us to create an innovative and state-of-the-art pump station that provides true hurricane protection while giving us the ability to monitor and operate the station remotely in the event of a weather emergency. We chose electric which run quieter with less impact so as not to disrupt the adjacent residences. The pump station keeps water out of homes and roadways while providing added flood protection to residences, businesses, public buildings, and thousands of residents.

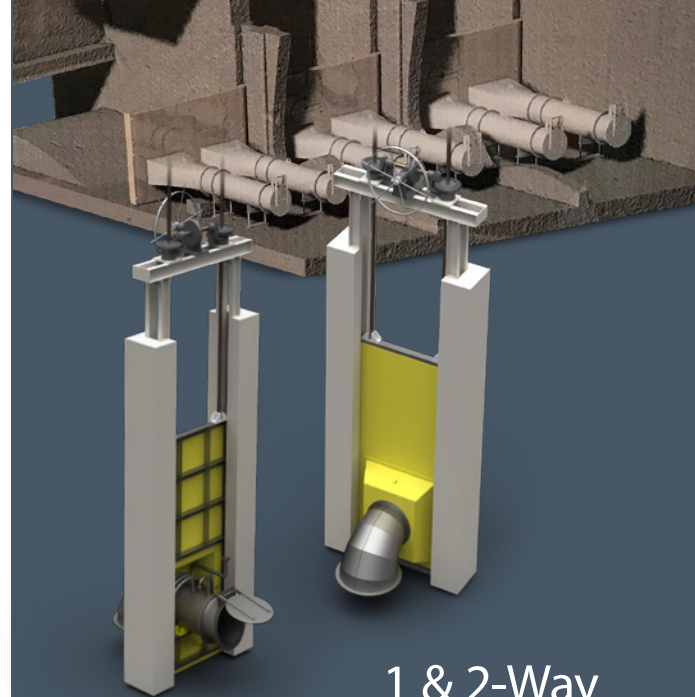

1 & 2-Way Gate Pump System

Turn any location with an existing gate into a pump station. MWI has been creating 2-way water pumping systems for decades. Choose from cast iron slide or flap gates, fabricated slide or flap gates, rectangular butterfly gates, stop logs, lifts and additional accessories.

- Simple design makes maintenance easy
- Efficient pumps save money on operating costs
- Lightweight yet durable sluice gate
- Intake bell designed to minimize vortex under low water levels
- Easy to install, low installation costs
- Durable and corrosion-resistant construction
- Can be custom designed to fit your specifications and existing structure
- No additional civil works, created to fit standard gate

Components & Options

- | | | |
|---|--|----------------------------------|
| 1. Wire Connection Chamber, Junction Box | 9. Thrust Bearings | 18. Double Cable Seal |
| 2. Upper Support Bearing | 10. Moisture Detection Probe | 19. Intermediate Support Bearing |
| 3. Stator Winding with Thermal Protection | 11. Dual Mechanical Seals | 20. Mechanical Seal |
| 4. Dynamically Balanced Rotor | 12. Lip Seal | 21. Speed Reducer Assembly |
| 5. Motor Housing | 13. Replaceable Liner | 22. Pump Bowl Shaft |
| 6. Pump Shaft | 14. Propeller with Taper Lock Attachment | 23. Motor Shaft |
| 7. Pump Bowl Assembly with Flow Straightening Vanes | 15. Intake Bell with Guide Vanes | |
| 8. Accumulator | 16. Control Cable | |
| | 17. Heavy Insulated Power Cable | |

Each pump can be made with either a cast or fabricated process.

Due to continual improvement of our products, we reserve the right to change designs and specifications.

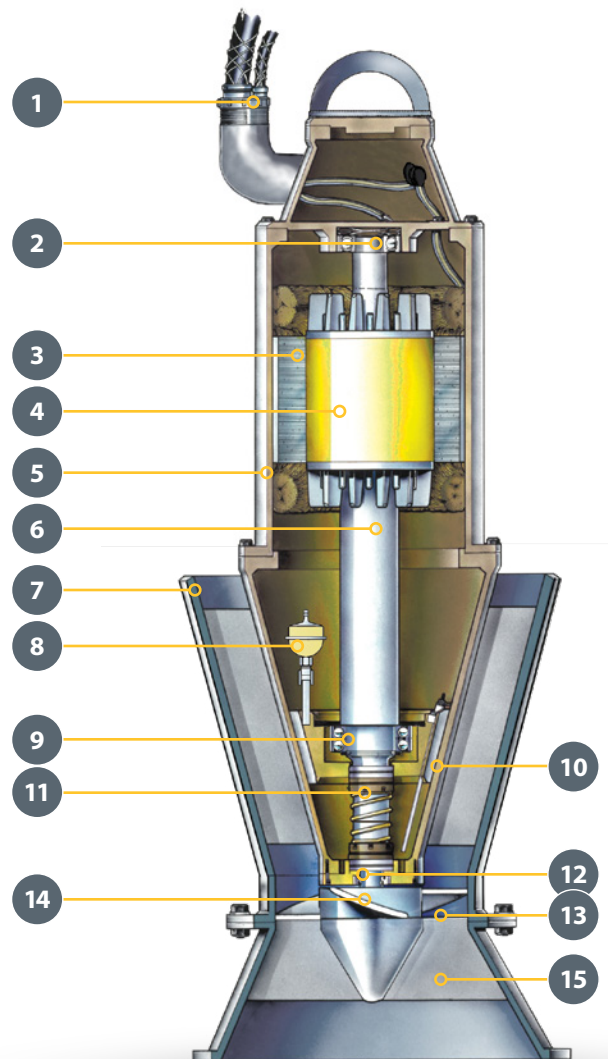
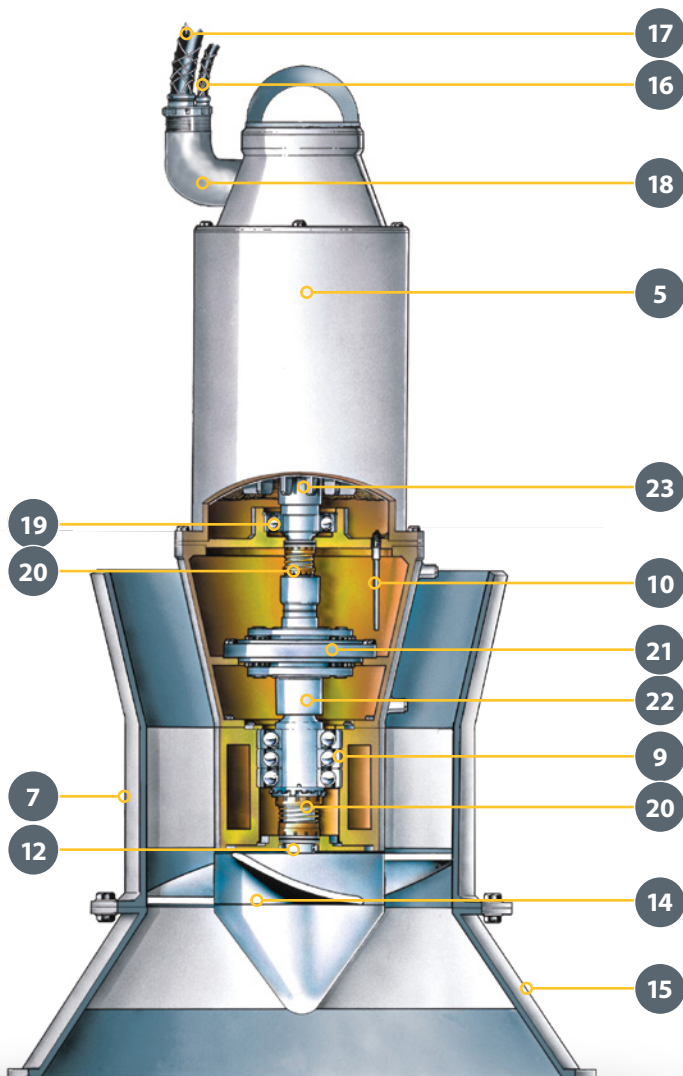

MATERIALS & OPTIONS	
Intake bell	A36 steel (304 and 316 stainless steel available)
Impeller hub	A36 steel (304 and 316 stainless steel available)
Impeller blades	304 stainless steel (316 stainless steel available)
Impeller wear ring	304 stainless steel (316 stainless steel available)
Pump shaft	1045 steel with stainless steel plating in seal surfaces (304 and 316 stainless steel available)
Diffuser housing	A36 steel (304 and 316 stainless steel available)
Lip seal endplate	304 stainless steel (316 stainless steel available)
Bearing box	304 stainless steel (316 stainless steel available)
Motor housing	304 stainless steel (316 stainless steel available)
Motor junction box	304 stainless steel (316 stainless steel available)
Junction box lid	304 stainless steel (316 stainless steel available)
Fasteners	18-8 stainless steel (316 stainless steel available)
Mechanical seal faces	Silicon carbide
Thrust bearings	Angular contact
Coating	Intergard 345 epoxy

Materials

MWI submersible electric water pumps are custom built to the customer's specifications. Our in-house team of professional, certified engineers work with our clients to customize the application-focused product while providing the highest quality service.

The materials and options shown are typical, but alternative materials are available. MWI can manufacture in exotic materials - for example duplex-type stainless steels, if requested. Each pump size, dimension, construction and capacity will vary based on customization to meet the needs of the customer.

Performance

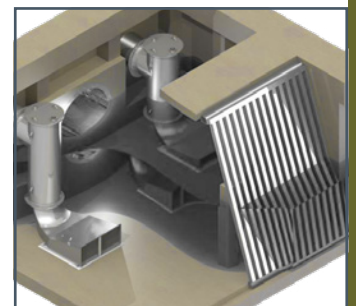
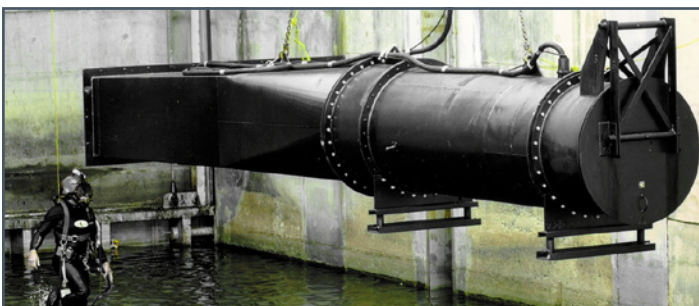
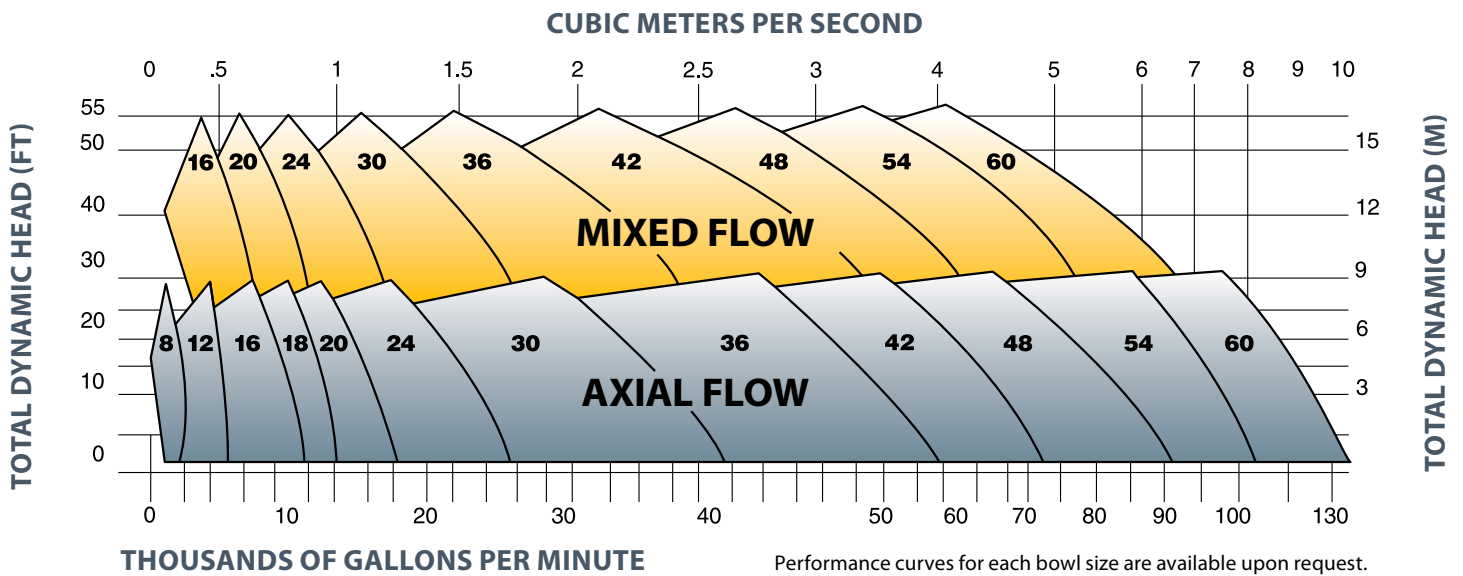



About MWI Pumps

MWI Pumps is an American-made ISO 9001:2015 and 14001:2015 certified pump manufacturer based in Deerfield Beach, Florida. Each pump is constructed using innovative, patented design concepts and heavy-duty materials to ensure durability and reliability. Further quality measures include indoor testing per H.I. 14.6 for flows up to 150,000 GPM. Our pumps are offered at competitive prices, and we always put our customers at the first. With our in-house team of engineers, years of experience, product variety, extensive rental fleet, and ability to customize each pump, we meet or exceed the needs of any job no matter the size.

Founded in 1926, MWI Pumps specializes in the design, manufacturing and construction of high-efficiency, large-volume axial- and mixed-flow propeller water pumps, centrifugal and mobile pumps, and village water supply units. Known around the world to be proven and safe, our industrial rugged pumps are ideal for a variety of applications, including:

- Construction dewatering
- Sewage bypass pumping
- Flood control
- Emergency pumping
- Final effluent
- Storm water pump stations
- Open pit dewatering
- Water management
- Dam bypass
- Agricultural pumping and more

MWI has provided professional pump rental and repair services since 1968, with locations throughout Florida, and representatives throughout the USA and worldwide. Contact us to learn more about our water pumps, pump repair, pump sales, cost-effective rentals, and other industrial water pump manufacturing services.

MWI Pumps

33 NW Eller Street, Deerfield Beach, FL 33441

General Inquiries: 954-426-1500 | Emergency Tel: 772-770-0004

mwipumps.com

Copyright © 2024 MWI Pumps

All rights reserved. Subject to change without notice.