

Open Link Chains

LONG LINK CHAIN

Gr3/Gr4 Extra Long Link Chain

Chain dia [mm]	No of links per meter	Link dimensions		Workload	Breakload	Weight [kgs/m]
		A [mm]	B [mm]	Gr3 [t]	Gr3 [t]	
5.6	44.6	19.6	22.4	0.30	1.5	0.62
6.3	39.7	22.1	25.2	0.38	1.9	0.78
7.1	35.2	24.9	28.4	0.48	2.4	0.99
8.0	31.3	28.0	32.0	0.62	3.1	1.25
9.0	27.8	31.5	36.0	0.78	3.9	1.59
10.0	25.0	35.0	40.0	1.00	5.0	1.96
11.2	22.3	39.2	44.8	1.20	6.0	2.46
13.0	19.2	45.5	52.0	1.60	8.0	3.30
16.0	15.4	60.0	64.0	2.50	12.5	5.01
20.0	12.5	72.0	80.0	3.8	19.0	7.83
26.0	9.4	94.0	106.0	6.5	32.5	13.23

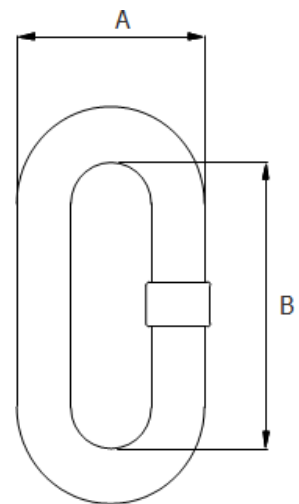

EXTRA LONG LINK CHAIN

Gr3/Gr4 Extra Long Link Chain

Chain dia [mm]	No of links per meter	Link dimensions		Workload	Breakload	Weight [kgs/m]
		A [mm]	B [mm]	Gr3 [t]	Gr3 [t]	
7.1	23.5	28.4	42.6	0.48	2.40	0.89
10.0	16.7	40.0	60.0	0.96	4.80	1.77
13.0	12.8	52.0	78.0	1.62	8.10	3.01
14.0	12.0	56.0	84.0	1.88	9.40	3.47

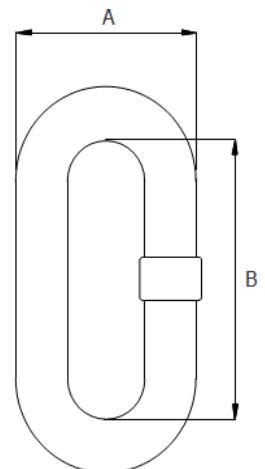

16.0	10.4	64.0	96.0	2.46	12.30	4.53
------	------	------	------	------	-------	------

Chain finish

- 1. Stainless steel – A type of steel that does not readily corrode, rust or stain with water.
- 2. Black – The chain is in it’s natural state and has no additional coating.
- 3. Electro galvanised – A layer of zinc is bonded to the chain using electricity, to protect against corrosion.
- 4. Hot- dip galvanised – A layer of zinc is coated on the chain by immersing the chain in a bath of molten zinc, to protect against corrosion.

1

2

3

4

