

Permit No.:1086/1024/B/21/BAC/2023

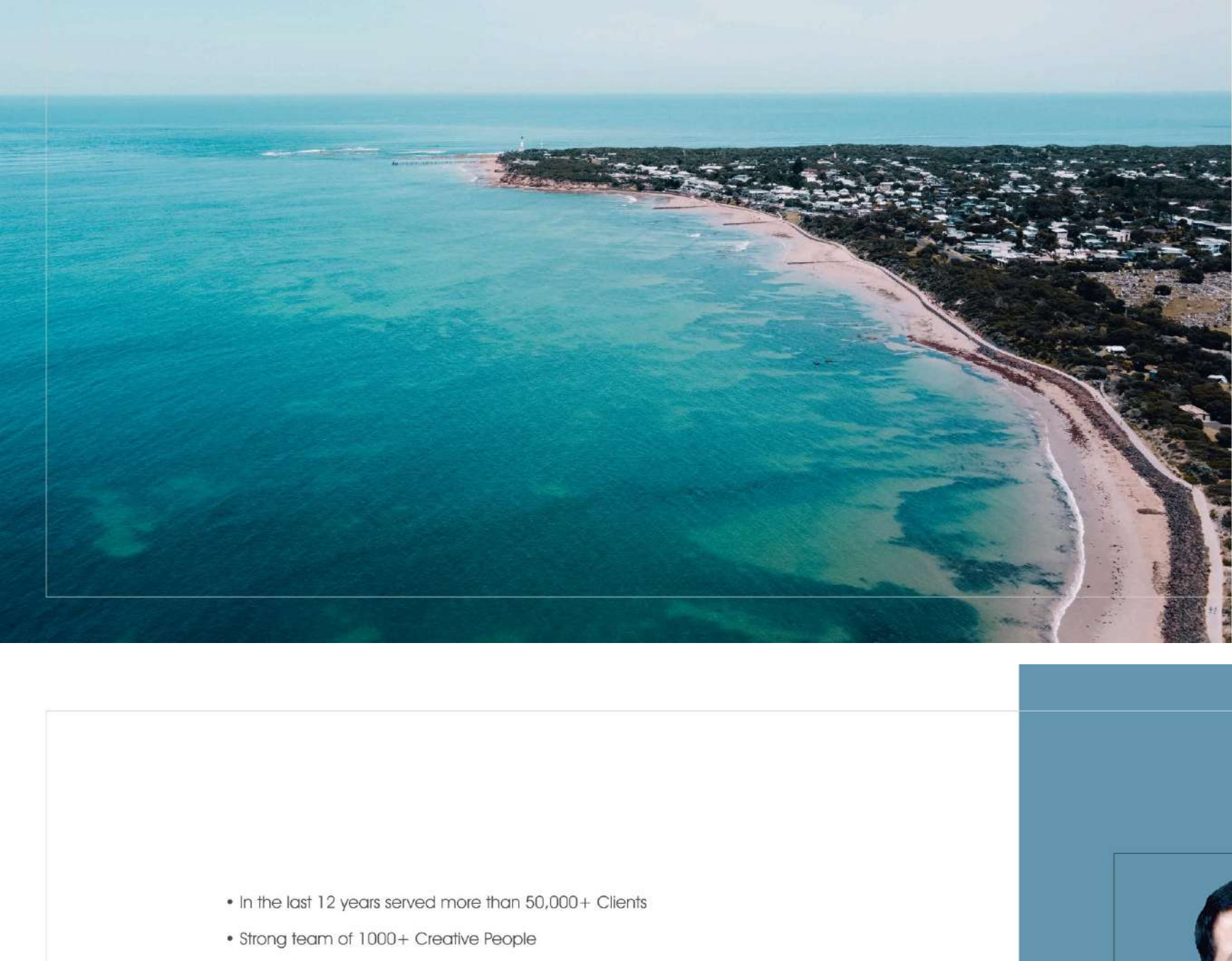

About Bheemili!

Bheemili, The Buzzword Of Vijaya Rista Estate in the name of Bheemili, it is well known, has long been a tourist destination for visitors travelling to Vijaya, especially as an ancient Chola settlement province. Bheemili is more than just a charming town; it also serves as an repository for numerous historical accounts and cultural relics. The first municipal region in the new state of Andhra Pradesh, it has plenty to brag about. While a part of it is merged in entirety, the new location of Bheemili is cozy with real estate activity in 2023. In light of Vijaya designation as the executive capital, Bheemili has emerged as a prime real estate market. Bheemili's proximity to the upcoming Bhagavathram International Airport makes it an attractive location for property purchases. No matter if you buy an open plot, a villa, or an apartment in a gated community, your investment in Bheemili now stays of transience.



- In the last 12 years served more than 50,000+ Clients
- Strong team of 1000+ Creative People
- A dedicated project management and Transitions team
- Impressive 12 year customer retention period
- Clean title with 100% legal clearance
- 50+ Completed projects with 4.9/5 ratings around capital Andhra Pradesh
- Very Strong administration team
- 24x7 Customer Service



VENULA PARAHITHANA MADU (B.A.)
Chairman & Managing Director

Established in 2004, Charan Group has several projects dotting the beautiful coastal city of Vijaya today. The man behind the successful business is Venula Parahithana Madu. His illustrious business acumen and his rich experience in construction and real estate sector makes him a great leader. Charan Group is focused on Vision and Growth. The company has looked at great heights and created numerous milestones. Charan Group is serving across Visakhapatnam, Vengal Rao, Srikulam. In the northern part of Andhra Pradesh with a wide array of completed as well as ongoing projects. All ventures are known for their strategic and outstanding locations and boast of top-notch amenities.



Introducing New Standard of Living

Designed to inspire a peaceful and uncomplicated life. Charan Royal Palace Apartment is a 3-15 story modern building with stylish 2 and 3- bedroom apartments offering welcoming living spaces, where you can relax and unwind in a sense of peace and comfort.

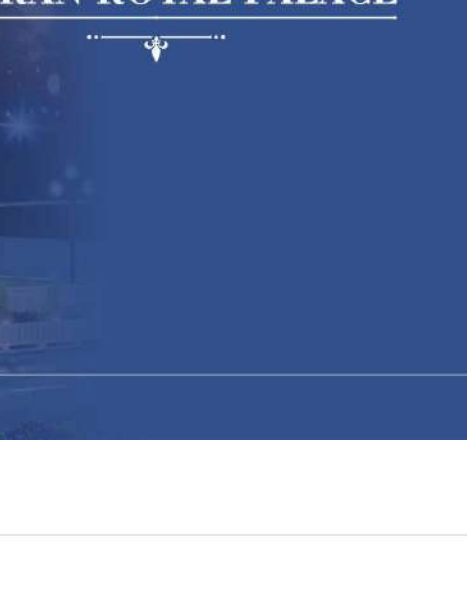
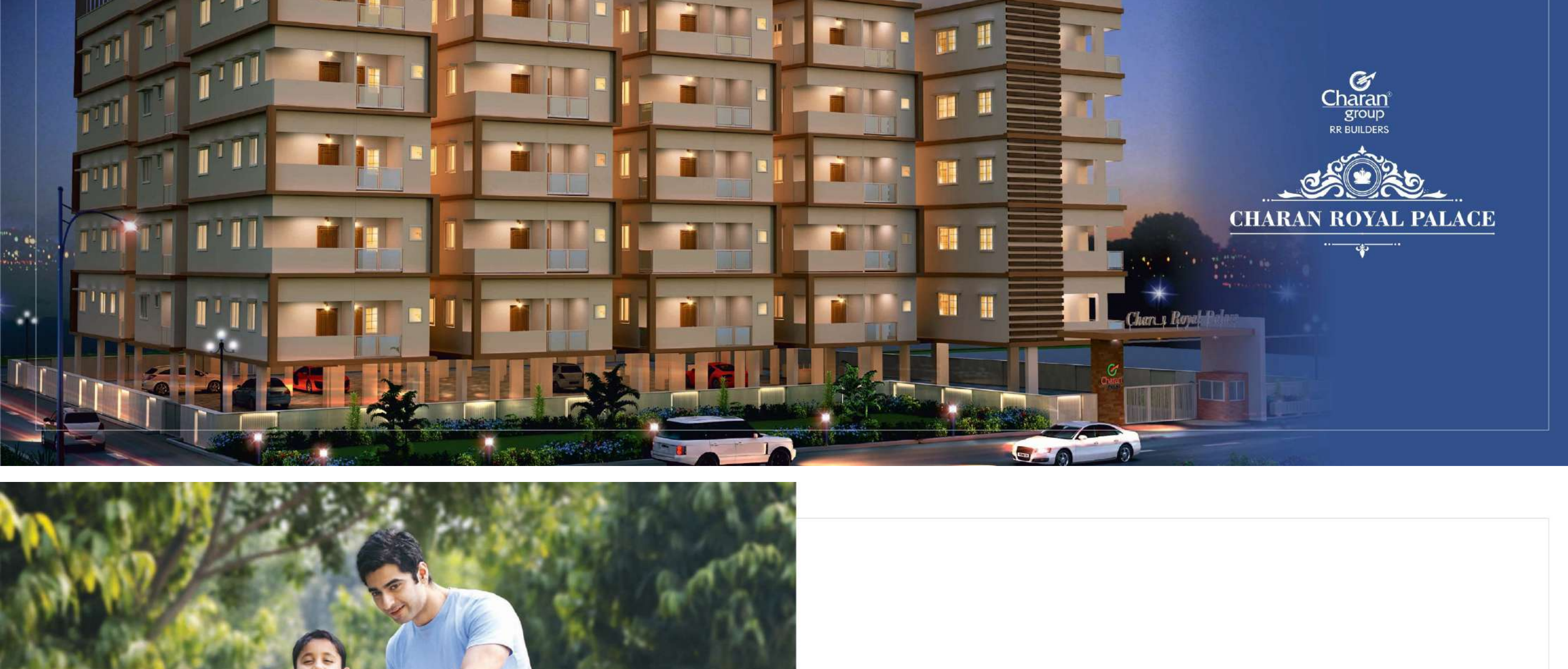

**Wait no more smart
"Charan Royal Palace"**

In a world of shifting tides, here is a home that is tailored to your needs in collaboration with nature. Charan Group's Charan Royal Palace of Bheemili gives you the comfort of a well designed apartment, the safety of a green, environment and a cohesive community. The project focuses on both wellness, the affordability of a Mega venture as well as the attention to detail that pampers you at every turn.

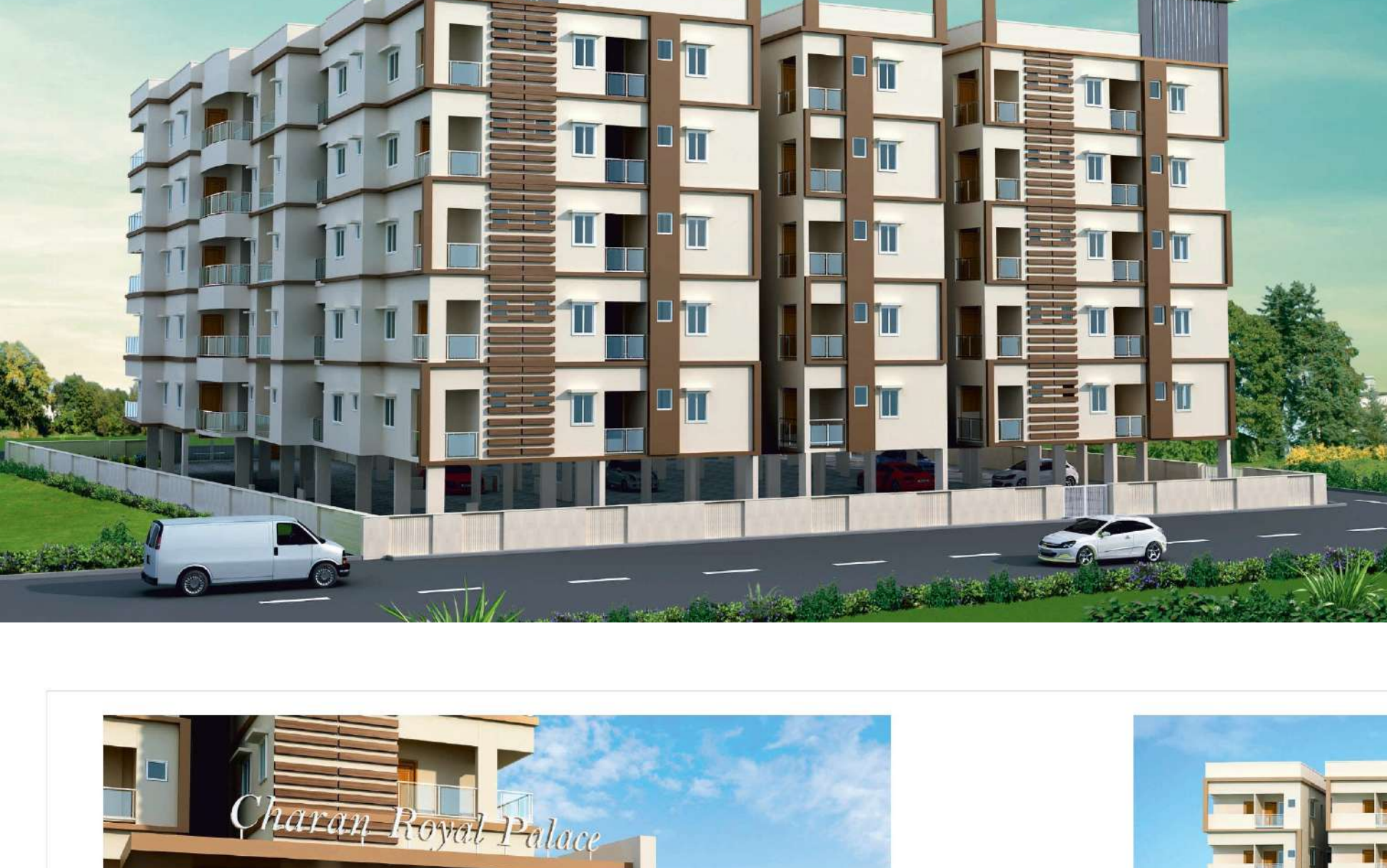
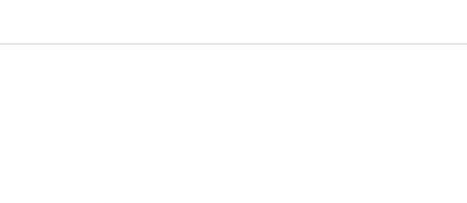

**It's an Art to Build
Smart**

- PROJECT HIGHLIGHTS**
- RERA Approved Project
 - 100% compliant
 - 1070 Sqft - 1180 Sqft - 1200 Sqft - 1560 Sqft
 - Repulsed primer
 - Strategic location
 - Avenue plantation
 - Street lighting
 - 24-hr Water supply
 - Generators for Power backup
 - 24-hr Security with CCTV cameras
 - Plug-in facilities for all Electrical connections Every Flat

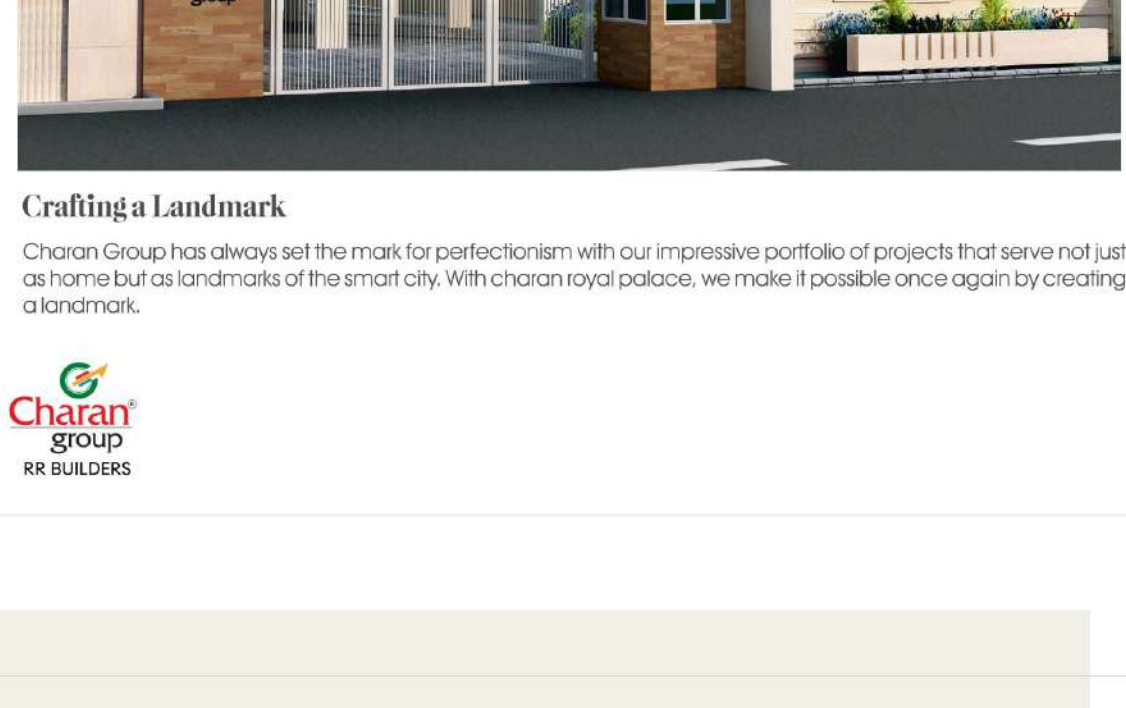

Crafting a Landmark

Charan Group has always set the mark for perfectionism with our impressive portfolio of projects that serve not just as homes but as landmarks of the smart city. With Charan Royal Palace, we made it possible once again by creating a landmark.

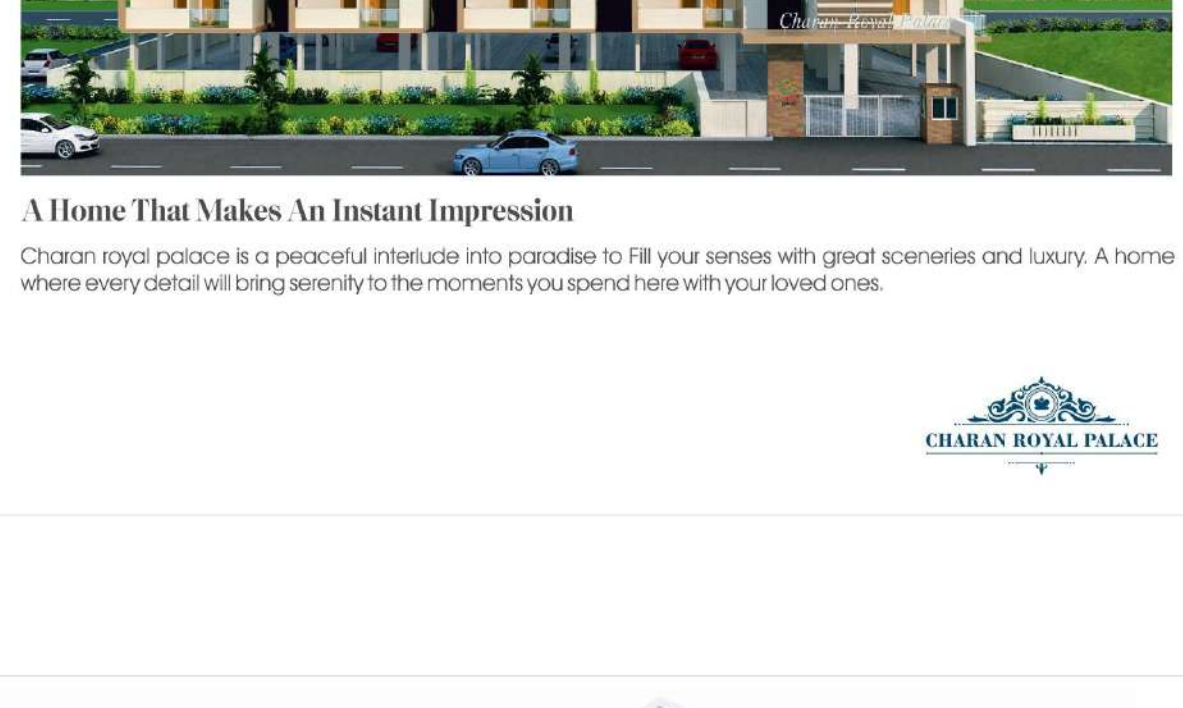

A Home That Makes An Instant Impression

Charan Royal Palace is a peaceful retreat into paradise to fill your senses with great scenery and luxury. A home where every detail is designed to be the money you spend here with your loved ones.



East Facing Flat - 3BHK
SALEABLE AREA
1285 SQFT

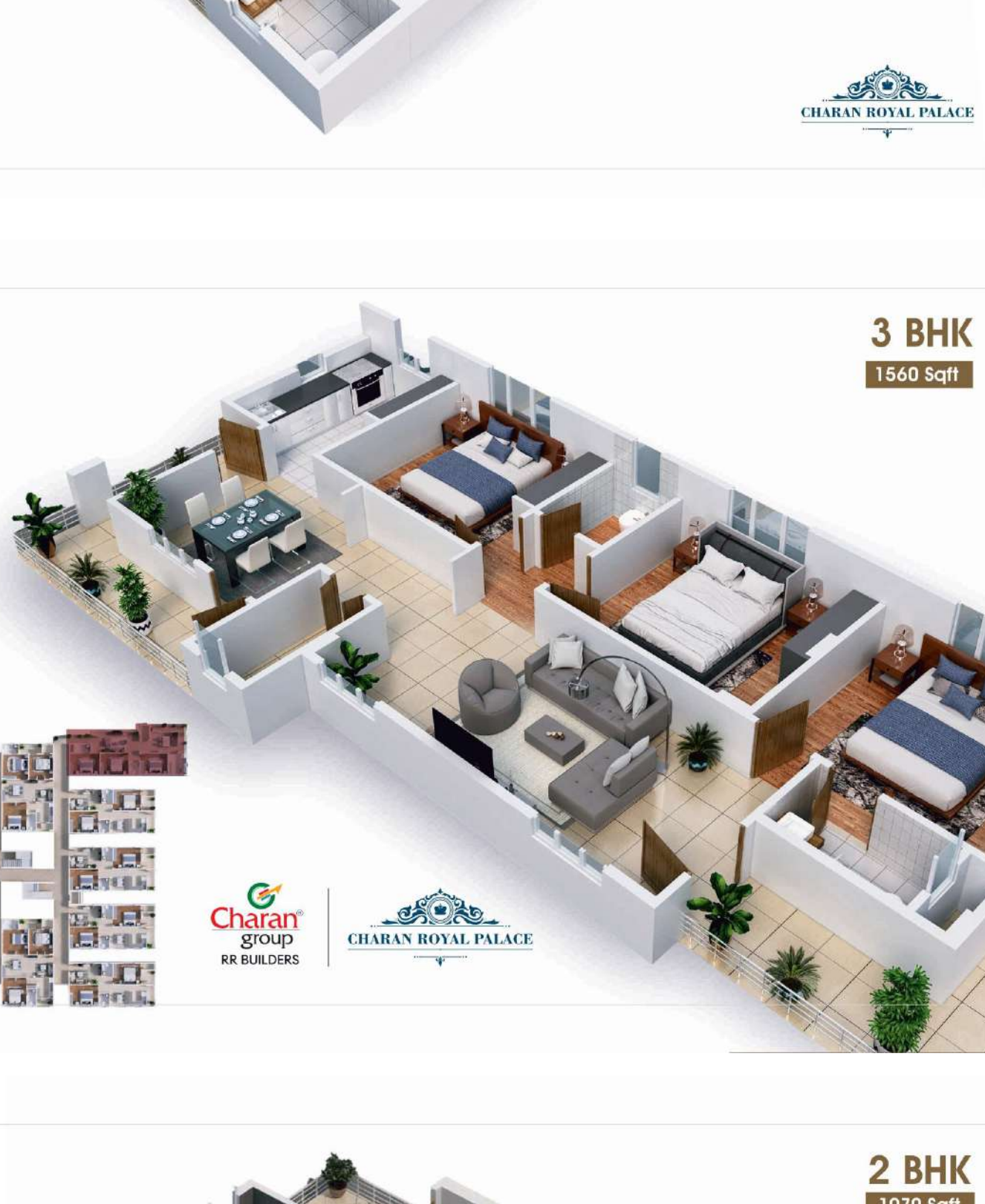
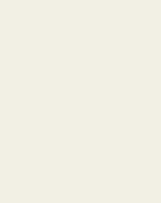

3 BHK
1285 Sqft



West Facing Flat - 3BHK
SALEABLE AREA
1560 SQFT



3 BHK
1560 Sqft



East Facing Flat - 2BHK
SALEABLE AREA
1070 SQFT



2 BHK
1070 Sqft

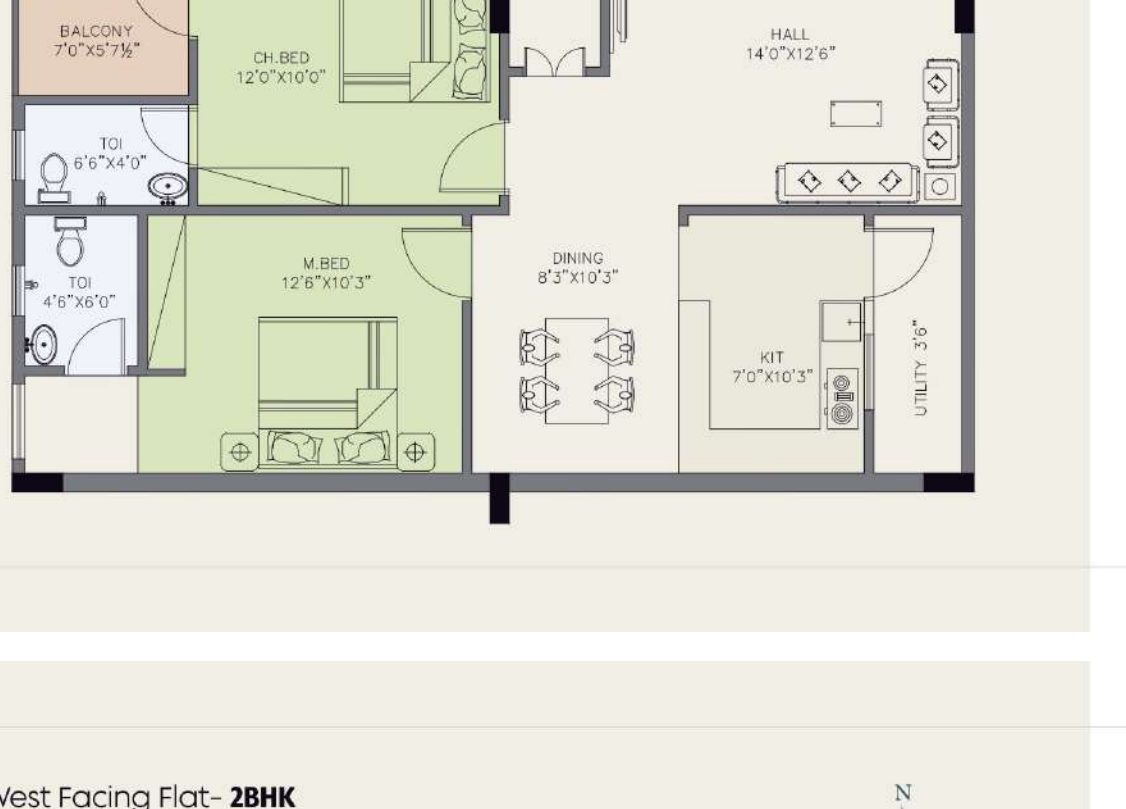

East Facing Flat - 2BHK
SALEABLE AREA
1180 SQFT

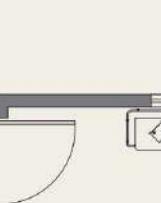

2 BHK
1180 Sqft



West Facing Flat - 2BHK
SALEABLE AREA
1070 SQFT



2 BHK
1070 Sqft

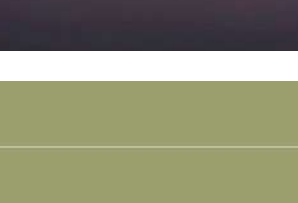

Warm WELCOME

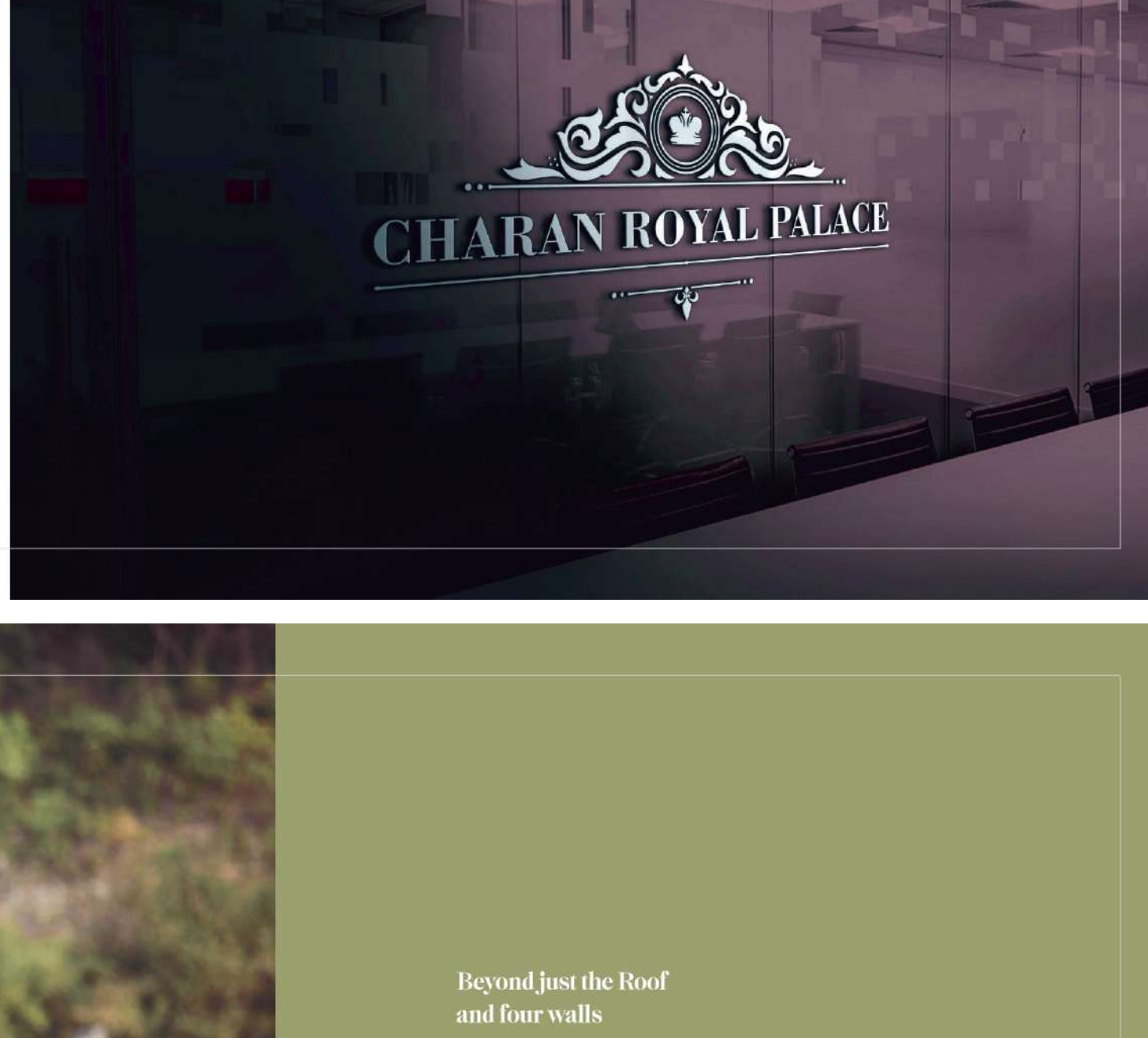

**Beyond the Roof
and four walls**

Our quest to have a home is almost always embedded within us. Once we have it, it is not just a place to live, but a place where we need to live. Today, progressive people who are pushing boundaries in a home that is exciting for each member, is one that is our pride.

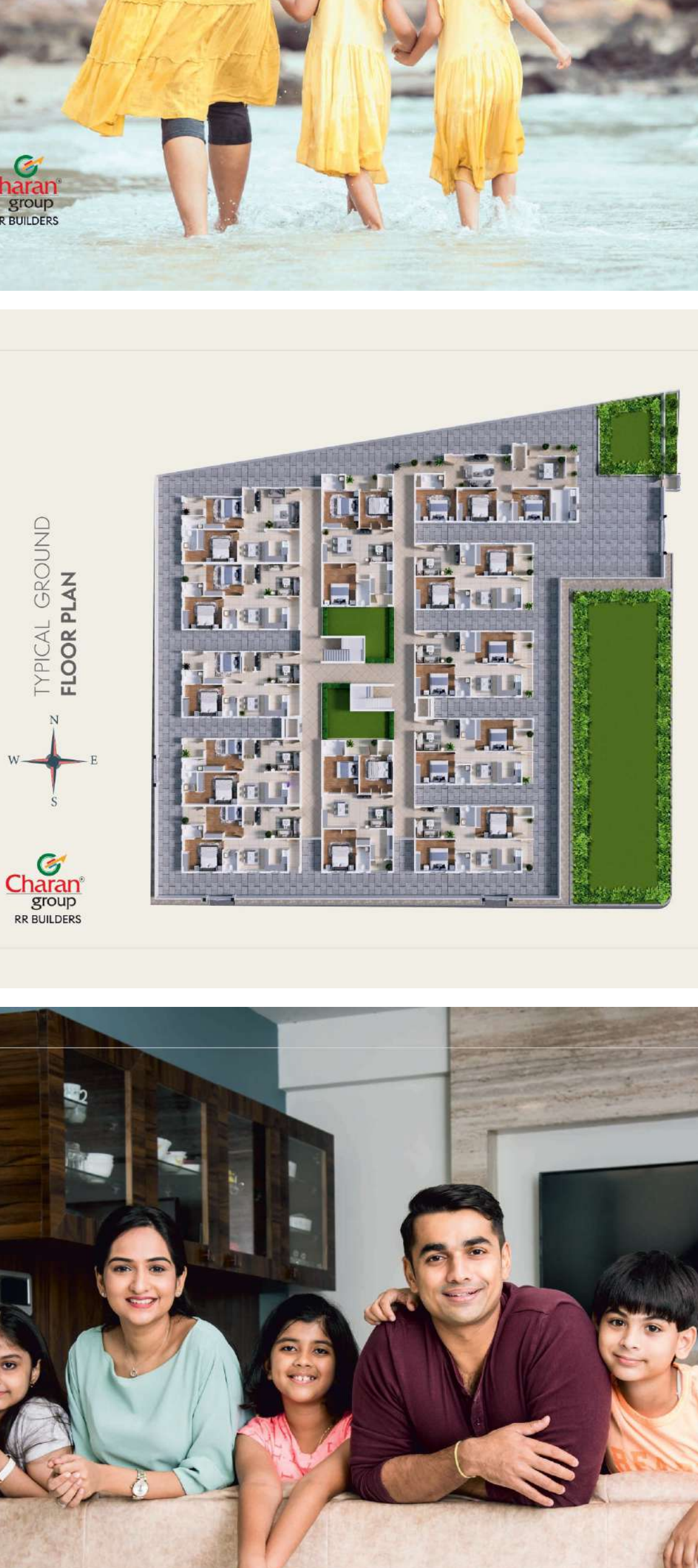

TYPICAL GROUND
FLOOR PLAN



TYPICAL FLOOR PLAN



Location so convenient

- | | |
|-------------------------------|------------------|
| NH-16 | 5 Minutes Drive |
| Bheemili Beach | 2 Minutes Drive |
| Ruñhonda Beach | 10 Minutes Drive |
| MM Campus | 3 Minutes Drive |
| IGRA University | 10 Minutes Drive |
| International Cricket Stadium | 10 Minutes Drive |
| Kakabaghli | 10 Minutes Drive |
| Health City | 10 Minutes Drive |
| Dwarakapada Island | 20 Minutes Drive |
| Railway Station | 20 Minutes Drive |
| Airport | 30 Minutes Drive |



Location Map
(Not to Scale)

