

CARGO LASHING AND TIE-DOWN EQUIPMENT

Cargo Ratchet and Strap with J-Hook

Lashing straps can be supplied with J-hooks, D-rings or Open claw end fittings

Lashing Ratchet

MBL	Tail Length	Tail Width	Weight
[t]	[mtr]	[mm]	[kg]
0.80	0.40	25.00	0.29
4.00	0.40	50.00	1.30
10.00	0.50	75.00	2.00

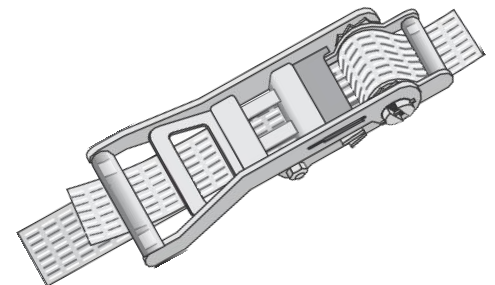

Lashing Strap with J-Hook

MBL	Strap Length	Strap Width	Weight
[t]	[mtr]	[mm]	[kg]
0.80	1.00	25.00	0.09
0.80	2.00	25.00	0.11
0.80	3.00	25.00	0.13
4.00	9.00	50.00	1.08
4.00	12.00	50.00	1.39
4.00	16.00	50.00	1.85
4.00	18.00	50.00	1.91
10.00	12.00	75.00	2.00

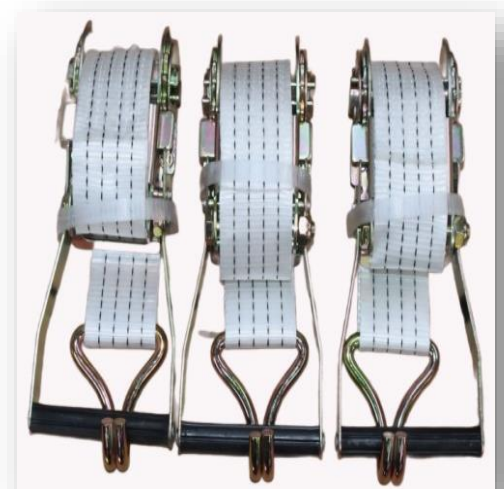

Grab Hook - Heat treated and tempered

Chain Size	A	B	C	D	E	F	Weight
[mm]	[mm]	[mm]	[mm]	[mm]	[mm]	[mm]	[kg]
10	68	12.7	114	11	68	11	0.5
13	84	16.7	143	14	85	15	0.9

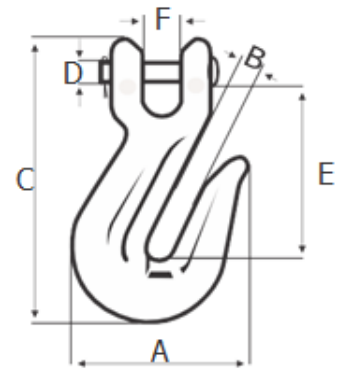

Load Binder - Lever Type

Chain Size	MBL	Lashing Capacity	Take Up	Handle Length	Weight
[mm]	[t]	[t]	[mm]	[mm]	[kg]
10	8.563	2.450	102	405	3.5
13	14.97	4.175	115	470	5.1



Load Binder - Ratchet Type

Chain Size	MBL	Lashing Capacity	Take Up	Handle Length	Barrel Length	Weight
[mm]	[t]	[t]	[mm]	[mm]	[mm]	[kg]
10 / 13	14.97	4.175	200	356	254	5.6

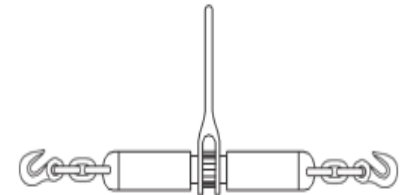

Transport ring

Working load limit	Break load	Inside width	Outside length	Material diameter
[t]	[t]	[mm]	[mm]	[mm]
1.0	4.0	41.0	78.0	13.0
2.0	8.0	42.0	88.0	14.0
3.0	12.0	45.0	94.0	17.0
5.0	20.0	55.0	118.0	22.0



Twist Locks

SINGLE



DOUBLE



Truck Winches



Available in : 125mm and 150mm